

SOCIETY HILL CIVIC ASSOCIATION

# THE RESIDENT NEWSLETTER

Box 3, Philadelphia, Pennsylvania 19105

December 1981

## SHCA General Meeting of September 9th

SHCA president Michael Willmann began the meeting by discussing the quadrant system and introducing the members of the SHCA board who were present.

Willmann introduced the heads of the various SHCA committees who discussed what was being done and answered questions from members.

Tony Schneider, head of the Traffic and Parking Committee discussed the new city resident sticker parking law. This allows residents on certain marked residential streets to ignore two hour limit signs if they have a city sticker for that zone. Society Hill is sticker zone five. You can get your sticker at the concourse level of the Municipal Services Building, but your car must be registered at an address in the zone. Many more residential streets will be posted, and all 100% residential streets can qualify to be included in the sticker system.

Tony Schneider also discussed area real estate taxes, saying that City Council and the mayor reached an agreement last year, but that there was a lot of ambiguity about what the agreement meant. Anyone with questions about this should contact him.

Liz Ostrander of the Clean Streets Committee said that if you see littering or someone putting their garbage in the litter baskets, you should call the Litter Hotline at 686-5646. If you know someone who consistently violates the litter, garbage or dog-dropping laws, call the Sanitation Police at 686-3082.

Tom Gould gave a report on our neighborhood's Town Watch, saying that 300 people had signed up and that patrols were getting under way. **If you are interested in helping out call 629-1323 between 9 a.m. & 10 p.m.!**

Bob Holtz (at the time, chairman of the Low Income Housing Committee,

a post now held by Liz Ostrander) gave a summary of the case since 1972. The SHCA's position has always been that it is in favor of resettling the plaintiffs in the Dodson case in the neighborhood, but that it feels this should be done in existing housing. The SHCA also objects to the concentration of new construction along Sixth Street, and notes that the density of two of the units is double the density called for in the redevelopment plan. The issue of Olan Lowrey as the attorney representing the neighbors was raised and Holtz said that we were sticking with Mr. Lowrey because the neighbors most

concerned supported him, because it would cause a great deal of delay to switch lawyers now, not to mention the expense of educating a new lawyer in the history and intricacies of the case, and because we have had a funding problem and Olan has been very reasonable about money.

Holtz said that the construction was able to start because the city had the necessary variances a year ago.

Dick Ostrander, treasurer of the Society Hill Housing Foundation, said \$19,598 had been collected, but that more was needed. He pointed out that contributions to the foundation were tax-deductible.

## Mark Your Calendars!

The next meeting of the Society Hill Civic Association will take place at Old Pine Community Center, 4th and Lombard Sts. on Wednesday evening, December 9th at 8 p.m.

Items on the agenda include a report on the City's 300th birthday

plans which will bring tens, perhaps hundreds, of thousands of people to our neighborhood, a report on the low cost housing situation on 6th Street, an update on the hotel-be-be—or not-to-be—on the Dock Street site across from Bookbinders, and a brief presentation by the Big Brothers/Big Sisters program. The general meeting will be preceded by a SHCA board meeting at the center at 6:30 p.m.

Fred Stein, the coordinator of Century IV will present the City's plans for the year-long birthday celebration including the "Tall Ships" flotilla which will bring many visitors to Penn's Landing.

In addition, a special election will be held to replace H. Wallace Roberts, a former director from the Northwest quadrant. Write-in ballots are welcome. The Northwest quadrant is bounded by Walnut St. on the north, Fourth St. on the east, 8th St. on the west and the south side of Spruce St. on the south.

### Thank You, Thank You

The *Resident Newsletter* staff wish to thank Charles Peterson, Liz Ostrander, Ed David Wohlmuth and Ellie Gesensway for their contributions to this issue.

\* \*

We welcome your letters, comments and contributions. Address all correspondence to *Resident Newsletter*, P.O. Box 3, Phila., Pa., 19105 or get in touch with a member of the staff: Ruth Dugan, Nancy Frenze, Alan Halpern, Tim Lemmer, Peg Robb and Jan Stephano.

# Lits Lights a Fire

A September 23rd rally sponsored by the recently-formed Let "Lits" Live Coalition has proved to be the catalyst for a broad-based effort to save the distinctive Victorian landmark of Market Street East. It is listed on the National Register of Historic Places.

In the days following the rally that was attended by over 600 people, many of them from Society Hill, City Council passed a resolution introduced by Councilman Tayoun asking for the building's preservation. Mayor Green directed his staff to seek preservation alternatives to demolition, and the University of Pennsylvania, holder of the mortgage, announced its opposition to demolition.

The *Philadelphia Inquirer* and KYW radio have printed and aired repeated editorial endorsements. The Lits story is featured this month in *Preservation News*, journal of the National Trust for Historic Preservation which

has determined that the buildings are of national significance as one of the largest remaining intact blocks of Victorian commercial structures in the country.

The fight is far from won. Initial discussions between the current owner, City Stores, Inc., with their unnamed proposed New York developer and city representatives headed by Director of Commerce and City Representative Richard Doran seemed promising. However, it now appears that the developer has made unacceptable demands in return for preserving the facades, including retaining the option to tear them down after two years.

In the words of a November 15th *Philadelphia Inquirer* editorial, "The city must back up its positive bent by withholding any lease-back agreement until there are assurances that

the facade will be retained permanently."

Let's not lose another Philadelphia landmark. The Coalition needs your help. Write to Mayor Green, 215 City Hall, Philadelphia, PA 19107 and to Richard Doran, 1660 Municipal Services Building, Philadelphia, PA 19107. Let them know that you expect them to stand firm on their expressed desire to preserve the Lits facades. Urge them to make it clear to this or any other developer that the city will not support with agency assistance, tax dollars, or the city's credit any future development of the Lits site that fails to assure preservation of the facades.

Contact Eleanor Gesensway, chairman of the Let "Lits" Live Coalition (925-6795—evenings) if you want to assist in preserving our city's heritage.

# Low Income Housing Update

Testimony is complete in the case of the Society Hill Civic Association vs Patricia Roberts Harris, HUD, and the Philadelphia Redevelopment Authority. Judge Van Arsdale has ruled unfavorably on several SHCA arguments and should be finished with the case soon. Then it will go to the Third Circuit Court of Appeals.

A parade of witnesses testified that HUD threatened to withhold all Community Development funds for the entire city unless the units in Society Hill were built. Both Hille Levinson, City Director under Frank Rizzo, and Councilman James Tayoun testified that they urged HUD to use existing housing which was and is abundant but that HUD insisted on new construction on three specific sites on Sixth Street. Levinson said that the City had no choice but to comply and Tayoun added that Council was then forced to make the necessary zoning changes.

Former city planner and former SHCA board member Damon Childs and two long-time area realtors testified that property values in the area declined when the zoning was changed and would drop still further if and when the buildings are used for

Section 8 housing. Subsequently, Judge Van Arsdale ruled that property values would not suffer.

Two of the former tenants testified that they were shown housing in Society Hill and in the vicinity but that they were counseled by their advisors to refuse it.

The building continues on land valued at over \$500,000 but sold to a private developer for \$7000. When

complete, the 14 units with parking will rent for \$492-\$804 a month each—to be paid from public funds.

Over 250 people have contributed generously to the Society Hill Housing Foundation to support the lawsuit. Funds are still needed for the appeal. Those who want to join in this battle should fill out the coupon below and return it with a tax exempt donation,

To: SOCIETY HILL HOUSING FOUNDATION

Name \_\_\_\_\_

Address \_\_\_\_\_

Phone \_\_\_\_\_

I pledge \$ \_\_\_\_\_ (monthly/one time only) to support the anti-low income housing litigation. (Monthly pledges are for 3 months, 9/1/81—12/1/81)

Checks should be made to SOCIETY HILL HOUSING FOUNDATION and delivered or mailed to:

R. W. Ostrander, Trustee (phone 922-6179)  
408 South Sixth Street  
Phila., Pa. 19147

Please check if you'd like monthly pledge envelopes \_\_\_\_\_yes \_\_\_\_\_no

YOU'LL FIND PERFECT

# GIFTS



## NEWMARKET

Between Pine and Lombard on Second Street.  
Enclosed parking at 2nd & Lombard Streets.

Monday thru Saturday, 11 am till 9:30 pm  
Sunday 12 noon till 6 pm

# New Problems At Independence Place

The last meeting of representatives of neighbors (Washington Square East condominiums #1 and #2) with one of the developers, Joel Weisbein, and his attorney, Morris Dean, of Blank Rome Comisky & McCauley, took place on October 6th, 1981 in the office of Edward Edelstein, Esq. At this time neighborhood representatives, as a condominium coalition, discussed revisions they had made to the documents that impose restrictions on the developer during and after the construction of the twin towers. Condominium #1 residents are particularly concerned with how they will be protected from falling debris during the construction of the north tower. No concessions from either side were given at this meeting and another meeting is being scheduled at this writing which will include condominium representatives and a SHCA representative.

It was determined at the October 6th meeting that the developer had

succeeded in getting a variance to change the .7 parking space per unit requirement to .5 parking space per unit which leaves the developer free to build two luxury apartment towers accommodating 528 units and providing parking for only 264 cars—with the approval of the Redevelopment Authority. The question was raised because the developer's parking study by Pennoni Associates, Inc., dated January 1981 uses .5 parking space per unit in its study—the first time this figure has been used since negotiations began with the developer.

It WAS the City Planning Commission's stand and has always been the neighborhood's stand that the developer is under an obligation to come back to the neighborhood with a feasible parking plan for its approval. Moreover, the basis for all the meetings with the developer over the years has been to negotiate the variances to be appealed in exchange

for the neighborhood's endorsement of the project.

The parking study done by Pennoni Associates, Inc., referred to above was rejected by the two condominiums and the SHCA because it did not address many traffic and safety problems perceived by those who use the garage regularly. Two items of concern cited in the objection to this study were 1) how moving and garbage trucks would service Independence Place and 2) how safe access to the garage could be provided for residents of Condo #2 which is on the south side of the garage (all stairs to the garage are north of the driveway entrance and exit ramps). The first reply from Pennoni to these concerns, dated October 15th, 1981 reads as follows:

Item 1—"All moving trucks and garbage trucks will service Independence Place from the area of the Washington Square Garage where rental vehicles are currently left until they are moved to their proper location within the garage. There is sufficient length and width at this location to allow for these vehicles to service the facilities without interfering with vehicles moving into and out of the garage."

Anyone who uses the garage knows that the rental vehicles are now parked in a tow-away zone which blocks the entrance lane to the garage from both 5th and 6th streets.

Item 2—"Vehicular and pedestrian movement to the garage is dictated by existing conditions. Given existing and anticipated activity, current conditions are acceptable for access with pedestrians and vehicles interfacing within the garage and *along the ramps* (italics ours) with no unacceptable concerns for safety and convenience.

Garage users will note that those who use the ramp for a walkway interface with traffic in both directions and when rental cars, garbage or moving trucks are parked on the ramp, they are sharing one traffic lane with incoming and outgoing traffic and other pedestrians.

MORE—if you can stand it—in the next issue.

## A New Approach to Crime

Mark down this phone number and give it to your friends and neighbors:  
**629-1323.**

That's the number of the new "Community Line" now being operated by the Society Hill Town Watch. Town Watch needs your input to help deter crime in our community. Were you or a neighbor a victim of crime? Let them know of a burglary or other crime which has already been reported to the police. The incident will be added to the data base being collected by the group. This information is being used to pin-point particular trouble spots in the neighborhood and alert patrol teams to areas experiencing crime. Anonymous reports will be accepted.

It is important all callers understand the "Community Line" is for NON-EMERGENCY use only. Reports of crime in progress or other activities requiring immediate attention should go directly to the police at either 911 (emergency calls) or 231-3131 (routine police matters).

Operated seven days a week between 9 a.m. and 10 p.m., the Town Watch Community Line is also avail-

able for information on forthcoming events of the group, registration of new patrollers, and identification of your floor captain (in hi-rise apartments), block captain, quadrant coordinators and other volunteers in our neighborhood.

The "Community Line" is also available to senior citizens who may need special escort service for vital off-hour trips to the hospital or pharmacy. Residents requiring such a service must allow a minimum of one hour for a volunteer to be contacted to provide assistance. When calling, please be prepared to give your name, address and phone number and the location of the hospital or pharmacy you are required to visit. People who think they might need this new service are urged to register through the Community Line in advance to speed response time.

Your suggestions of additional community services which might be provided through this active phone line are welcomed. Contact your block captain or quadrant coordinator. You don't know who they are? Call Grace at the "Community Line."

## Learn the Ad Business the Easy Way

The *Resident Newsletter* needs a volunteer advertising manager. We want to bring a new manager in to work with our current manager on the February-March issue before taking on the job alone. Ads come easy to us, so we need someone personable who is well-organized and has time to do the footwork. If you qualify, call Nancy Frenze at 923-5459.

# GIRARD BANK

# & George®

# has a new address

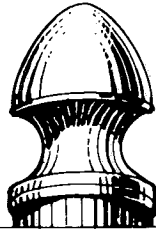

## QUEEN VILLAGE

Come visit the new Girard Bank in your neighborhood and learn about our new 28 George Bank-by-Phone® services. Sign up for any Girard account with George at Queen Village and you can do your banking Night and Day, Everyday, even on holidays and weekends.

The Queen Village office is located at 136-138 South St.

### Banking Hours

Monday thru Friday

11:00 a.m. to 2:00 p.m.

3:00 p.m. to 7:00 p.m.

If you would like to set up an appointment to discuss your banking needs call us at: 627-1126

### Customer Services available at Queen Village

#### Personal

- Transaction Accounts
- George Bank-by-Phone®
- George Automatic Teller Machines
- Statement Savings Accounts
- Trust Services
- Direct Deposit
- Loans
- Visa/MasterCard
- Investment Accounts (Bonds, Multipliers, Commercial Paper)

#### Business

- George Business Services
- George Automatic Teller Machines
- George Bank-by-Phone
- Business Checking
- Business Savings Accounts
- Business Loans
- Night Depository



**GIRARD BANK**  
FDIC

# HOUSE HUNTING



Do your house hunting at home - whether your move is across town or across the continent. We publish a new Homes For Living Magazine each month, featuring pictures, prices and descriptions of homes currently for sale in this area. And we have copies of other Homes For Living Magazines showing properties for sale in more than 9,000 communities in all 50 states, Canada and the Caribbean. Over 2,000 real estate offices cooperate to make this service available to you.

For any real estate need . . . call us. We can help.

Area Code (215) - 922-4200  
1215 WALNUT ST.  
PHILADELPHIA, PA 19107

**PLUMER  
LEVIT** REAL  
ESTATE INC.

Area Code (215) 925-2595  
226 SOUTH ST.  
PHILADELPHIA, PA 19147

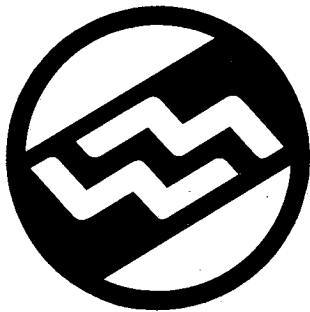

## OVERSEAS MOTOR WORKS Inc.

Import Car Service, Repairs & State Inspection  
*Specializing in Fine German Automobiles*

1501 Fairmount Ave.  
Philadelphia, Pa 19130

(215) 763-2300

# Saladalleyvalue

This coupon and

**\$5.95**

entitles you to our

Sunday Brunchbar,  
your choice of omelette, and a  
Bloody Mary. It's an **\$8.70 value**  
so you save **\$2.75**. Available Sunday 12-5pm.

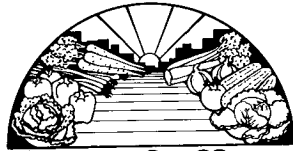

**Saladalley**

This coupon applies only at 1720 Sansom St. & The Bourse. Offer valid through Dec. 31, 1981. One coupon per person.

- 1720 Sansom St. (564-0767)
- The Bourse, at Independence Mall (627-2406)
- Suburban Square, Ardmore (642-0602)
- 4040 Locust St. (349-7644)

# Saladalleyvalue

This coupon and

**\$5.95**

entitles you to our

Special Weekend • Seafood Saladbar  
and a glass of house wine. It's an  
**\$8.45 value** so you save **\$2.50**.

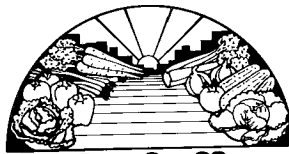

**Saladalley**

Available 5:30-10:00pm Fri, Sat, Sun at 1720 Sansom St.

Available 5:30-9:00pm Fri, Sat at The Bourse

This coupon applies only at 1720 Sansom St. & The Bourse. Offer valid through Dec. 31, 1981. One coupon per person.

- 1720 Sansom St. (564-0767)
- The Bourse, at Independence Mall (627-2406)
- Suburban Square, Ardmore (642-0602)
- 4040 Locust St. (349-7644)

*Rejoice in  
your holidays...  
within the limits of  
gentlemanly behavior,  
of course.*



NewMarket, Second Street between Pine & Lombard, Philadelphia, PA 19147

## What Are You Doing New Year's Eve?

Philadelphia's 300th birthday will be celebrated with a bang on New Year's Eve at Penn's Landing! The Friends of INHP and the City of Philadelphia are joining in opening Philadelphia's Tercentenary year at a gala party at the Port of History Museum. Lou Chaiken and his orchestra will again provide the music. In honor of the Philadelphia theme, Philadelphia food and champagne will be served at midnight, while the City sets off a barrage of fireworks over the river. Plan NOW to spend New Year's Eve with your friends and the Friends! For more information: 597-7919.

925-2882

**Old  
City  
Flowers**

Deliveries Citywide  
Exotic flowers & plants  
Unusual Arrangements  
31 South 3rd St., Phila., PA

## Specialized Tutoring

Certified Educational Specialist

ENGLISH • READING  
MATH • SPANISH  
STUDY TECHNIQUES

B.J. MILLER, M.ED.  
725-2176

# Deck the Hill: A Christmas Agenda

## December 8

- 7:30 a.m. Masses celebrating the patronal feast of Old St. Mary's Church.  
 11:45 a.m. Mary's Church.  
 7 p.m.

## December 11

- 10:30 a.m. Old St. Mary's Church—Opening of annual parish Eucharistic Devotion.  
 7 p.m. Old St. Mary's Church—Forty Hours Celebration.

## December 12

- 9:30 a.m. Mother Bethel African Methodist Episcopal Church. Young Peoples' Department. Christmas Bazaar.  
 7 p.m. Old St. Mary's Church. Forty Hours Devotion.

## December 13

- 2 p.m. Old St. Joseph's Church. Advent Christmas Choir Service of readings and carols.  
 3 p.m. Mother Bethel African Methodist Episcopal Church. Georgia Club Anniversary.  
 3 p.m. Old Pine. Philadelphia All-Girls Choir. "A Christmas Concert."  
 5:30 p.m. Old First Reformed Church (United Church of Christ UCC), Live Animal Nativity Scene opens, with sheep, donkeys, etc. 24 hours/day through December 30. SE corner 4th and Race Sts. 922-4566 for information.

Lisa M. Reisman

fine original art



Jules Cheret "Cosmydor Savon"

specializing in Art Nouveau and Symbolist prints and posters

also excellent works by 20th Century Masters and Museum Exhibition Posters. Catalogue Available \$1.00

By Appointment Only: Tel: (215) 923-3159

333 South Third Street • Philadelphia • Pennsylvania 19106



6 p.m. Community Christmas caroling. Meet at Old Pine or Old St. Joseph's. Bring a flashlight and cookies to share. Hot chocolate afterwards at Old Pine Community Center.

6 p.m. Mother Bethel African Methodist Episcopal Church. Candle Light Service.

7 p.m. Old St. Mary's Church—Solemn Closing of annual Eucharistic Devotion.

## December 17

8 p.m. St. Peter's Church. St. Peter's School Christmas Play, "Shepherds Play."

## December 18

11 a.m.- Old First Reformed Church (United Church of Christ UCC), Holiday Festival, food, home baked goods, and gifts.

11 a.m. St. Peter's School nurseries and Kindergarten Christmas Party; "Around the Tree."

## December 19

10 a.m. Mother Bethel African Methodist Episcopal Church. Sidewalk Sale. Benefit of Women's Day.

## December 20

11 a.m. Old First Reformed Church (UCC), Festival Worship Service.

3 p.m. Old First Reformed Church (UCC). Philadelphia Festival Chorus, Mary Greene, Director. Concert with Ralph Collier, Narrator. Reception following.

3 p.m. Mother Bethel African Methodist Episcopal Church. The Trustees Auxiliary presents The Jones' Singers in Concert.

7:30 p.m. Old Pine. Lessons and Carols. The combined choirs of Old Pine and Willow Grove Presbyterian Churches in an hour of beautiful sounds in a candlelit historical setting.

## December 22

10:30 a.m. Community Center. St. Peter's Lower School "Christmas Celebration of Carols and Poetry."

## Help Wanted

The Society Hill Town Watch will pay a small stipend to some person who is frequently at home to take our phone messages. Back-up will be provided by our answering machine. For details, call: 627-3030.



## December 24

- 5 p.m. Christ Church. Holy Communion.  
6:30 p.m. Old First Reformed Church (UCC). Live Nativity Tableau in Church Yard.  
7:30 p.m. Old First Reformed Church (UCC). Traditional Christmas Eve Candlelight Candle Service.  
7:30 p.m. Old Pine. Christmas Eve Service. Carol singing. Children come ready to be a character of the Christmas story. Bring non-perishable food gift wrapped in white.  
7:30 p.m. Old St. Joseph's Church. Christmas carols.  
8 p.m. Old St. Joseph's Church. Christmas Eve Mass with choir.  
8 p.m. Holy Trinity Church. Christmas Vigil Mass.  
10:30 p.m. St. Peter's Church. Music by choir—men and boys.  
10:30 p.m. Christ Church. Christmas Oratorio by Bach. Christmas Eve Service.  
11 p.m. Christ Church. Holy Communion.  
11 p.m. St. Peter's Church. Christmas Eve Service.  
11:30 p.m. Old St. Mary's Church—Christmas music with brass ensemble and carol singing.

## December 25

- Midnight Old St. Mary's Church—First Mass of Christmas.  
6, 7:30, 9, Old St. Joseph's Church. Christmas Day Masses.  
10, 11 a.m.  
12:15 &  
5:30 p.m.  
10 a.m. Christ Church. Holy Communion.  
10:30 a.m. Old St. Mary's Church. Christmas Masses. & Noon  
10 a.m. St. Peter's Church. Holy Communion

## December 30

Old First Reformed Church (UCC) Live animal nativity scene closes for another year.

## December 31

- 10 p.m. Mother Bethel African Methodist Episcopal Church. Watch Night Service.

At the time we went to press the holiday schedule for the tree lighting and carol singing at Washington Square Park and the Hanukkah program at Society Hill Synagogue had not been firmed up.

# A Party Preview

Last February 1st, the SHCA hosted a membership party in conjunction with NewMarket. The purpose of the get together was to expand the membership of the SHCA and provide a convivial environment for all our neighbors to enjoy. They did enjoy—more than 300 of them.

So next year we'll be having another bash. It is being put together by a committee consisting of Joan Simon of Domsy-Simon Advertising Agency, Lu Bangert, Carol Berger,

Molly DeLaurentis, Nancy Frenze and Edna Wenk. The February 1982 merrymaking will feature wine, cheese, live music and lots and lots of neighbors. If you missed the last party, don't let it happen again! Look for a flyer in January with all the details.

Any member who wishes to volunteer some time to help with pre-party publicity should call Nancy Frenze, 923-5459.



WHERE IN THE WORLD ARE YOU GOING?

**TRAVEL  
NYWHERE**

SOCIETY HILL TOWERS MALL PHILADELPHIA, PA 19106

Use your neighborhood professional Travel Agent; located 16 years in Society Hill. Wherever & whenever you travel, call or come for Reservations & Tickets. Major credit cards accepted.  
AIRLINES, AMTRAK, HOTELS, CRUISES & CAR RENTALS.

Free Delivery

Phone 925-2123

Open 9-5 daily

# Zoning Update

**415 Spruce St.**—The present owner has guaranteed to the SHCA in writing not to use the guest room over the carriage house as a rental unit. This position is being restated in response to neighbors' questions about the appearance of two electric meters on the dwelling.

**509 Spruce St.**—Inquiries will be made to ascertain the reason why there is an electric wire running from property to an exterior street light.

**N.W. Cor of Third and Spruce**—Owner has been granted a permit for a curb cut on Spruce Street in non-conformity to the zoning of the rest of Spruce Street in the Society Hill, Washington Square and Center City areas.

**Tun Tavern**—City Public Property Commissioner J.W. Brown reports that the lease of the site at Spruce Street and Mathis (at Front St.) to a group of former Marines who proposed to build a museum there has expired. Brown has requested that the city incorporate the site into the present Penn's Landing park—a position endorsed by the SHCA.

**Dock St. site** (Bookie's parking lot)—The SHCA had endorsed the building of residential units here but the court ruled otherwise. And the city, which has long wanted a hotel or motel on the site, signed up a hotel developer—Radisson together with local insurance company Fidelity Mutual. Last month when Bill Green wouldn't let Fidelity Mutual develop a condo-

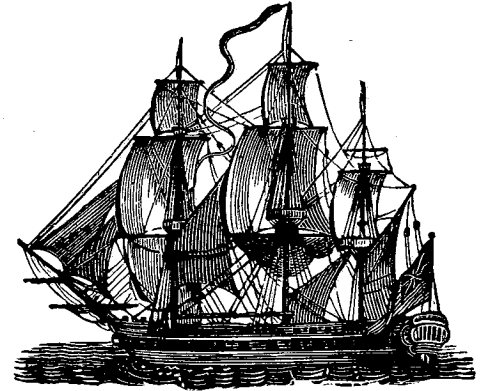

minium on a property it owned in Fairmount, the company pulled out of all its projects in Philadelphia until, it said, there would be a more favorable government climate. Neighbors who are still hopeful of getting residential development on the site, will not be cheered by the fact that Radisson is reported to be looking around for a new source of financing.

**COMPLETE OVERHAUL \$47**

Headquarters for **ZEBRAKENKO**

**SOUTH STREET BICYCLE SHOP**

630 South 4th St., Phila., 922-1283

**MARTIN BERNARD**

Master Hair Designers  
& Make Up Center 52 N. 2nd St.

One of Phila's "more significant" salons  
—Phila. Mag.

(215) 923-1115

**QUEEN VILLAGE ANIMAL CLINIC**

Howard Wellens VMD

Office Hours  
By Appointment  
925-5753

417 Bainbridge St.  
Philadelphia, Pa. 19147

**HIGHMEADOW FORGE**

**Decorative and Ornamental Ironwork**

Windows - Doors - Railings  
Individually Crafted Door Gates  
for your security

Walt Billings  
call (215) 925-2063  
evenings

# Around the Neighborhood

The day I talked with Lynn Roberts was the day after President Anwar Sadat was assassinated. As I was leaving, there on the hall table was a newspaper proclaiming in huge block print "SADAT SLAIN" and I said: "We never got around to talking about that." Lynn's reply was: "There's nothing I can do about *that*."

But there are many issues about which she can do something—and does. Most recently, after first discussing the matter with the SHCA and with Town Watch, she went to the police to get their help in protecting local teenagers from the marijuana pushers on South Street. She was not alone in this. South Street businessmen, concerned about the problem, also had approached the police. Following these efforts, a special officer was assigned and some improvement has been noted.

Lynn Roberts is an educational consultant by profession. A Vassar graduate with a master's from Temple in public administration (and working toward a Ph.D. which she laughingly says she might have by age 90), she evaluates programs and analyzes budgets. She has had contracts with the U.S. Department of Labor and works with the Pennsylvania Department of Education. She does budget analysis for the Citizens Committee on Public Education in Philadelphia and was an organizer of the Parents Union.

Always a political activist, Lynn says that most of her activity nowadays is on behalf of public education. "I am very much interested and believe in it. And we are fortunate in having a good public school in our neighborhood.

"The McCall School is well-integrated, not only black-white, but because it teaches English as a second language. There is a large number of oriental students including Vietnamese, Laotians and Cambodians. The school has such a good reputation," she notes, "that there is always a waiting list."

What about the future of the public school system in the city?

"It's hard to be optimistic at the moment," she says, "but I believe that with a good school board and a good superintendent—it's still a

viable institution." She observes that the schools have gone through several years of mismanagement and "we're paying the price."

The Roberts (Lynn's husband is Franklin Roberts, the theatrical producer who stages historical plays and spectacles for the National Park Service) have lived in Society Hill for 20 years. Franklin was one of the early presidents of the Civic Association. Lynn is not totally happy with how the area has evolved: "This used to be a people-oriented neighborhood," she said, "now it's property-oriented. Long before Town Watch was organized, we looked out for each other and for our houses.

"I know there has been growth and that brings changes. But I feel that many people have moved here because it's the 'in' place to live and they have no interest in humanizing

and developing the neighborhood. Being involved and caring is a big part of the quality of life."

Lynn Roberts has been involved with her neighborhood and her city in dozens of ways over the years. She used to lecture on 18th century art and architecture at the Fairmount Park Houses. In the days of live theater at TLA in the mid-'60s; she was an assistant set designer. She was also an associate producer of Marciarose's public affairs shows on television.

What does she do for fun? First of all, she says, her work is fun. She loves to travel, but has little time for it. However, you can see her flying up Walnut Street on her bicycle, which, she says, gives her a great sense of freedom. She enjoys cooking and isn't modest about her skills, but adds that she hates to clean up afterward. The Roberts have two children, Andrew, 15, and Laura, 11, and live on Delancey Street.

—Fran Israel

## Signs of the Times

The city has set aside \$40,000 for traffic and parking signs and SHCA was given some input to determine what the neighborhood wanted in the way of such signs. Tony Schneider coordinated the canvassing of each quadrant by its quadrant director. One recommendation was a sign directing visitors coming off Delaware Avenue at Dock Street to parking in the lot north of Bookbinder's. Another was for a stop sign at 2nd and Delancey. Recommendations do not necessarily have to be implemented by the city. A fuller report on neighbors' requests will appear in a future issue.

## Book of the Month

There is a vast amount of historical information about the buildings of Society Hill in the Library of Congress, most of it collected in the last 30 years. The descriptive catalog of this material titled *Philadelphia Preserved* has been out of print for several years. Temple Press has just issued an enlarged paperback edition and copies may be purchased at Carpenters' Hall, 320 Chestnut Street. 445 pages, illustrated, only \$10.95, tax included. It might make an ideal Christmas present.

## Get Out Your Crystal Ball

In order to plan effectively for the next few years (and beyond) the Long-Range Planning Committee of the SHCA is asking for your input. We want to know what is on your mind so that we can incorporate your ideas, suggestions and criticism into our future planning.

What do you see as the most important objectives of the SHCA over the next three to five years? Please list (or elaborate upon) *any* areas where you feel there is or will be a

need for action.

The committee is optimistic that you will take this opportunity to impact on future direction for Society Hill. Take the time to put your ideas down on paper now and mail them to:

Resident Newsletter  
Box #3  
Philadelphia, Pa. 19105

It is not necessary to sign your name. We look forward to hearing from you.

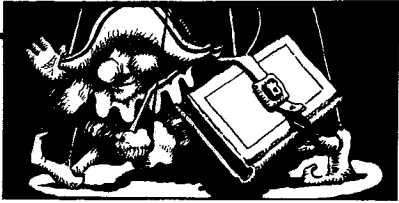

## BOOK MARK

### RARE & USED BOOKS

A sampling from out stock, ideal as gifts for this or any other season:

Bartlett, W.H. **Walks About the City and Environs of Jerusalem.** Bound in 3/4 leather. Illustrated with engravings. 1842.

Cervantes. **Don Quixote.** 3 volumes, in 3/4 leather. 1900.

Quiller-Couch. **Sleeping Beauty and Other Fairy Tales.** Illustrated in colour by Edmund Dulac.

Sparrow, Walter Shaw. **British Sporting Artists 1922.**

Twamley, Louisa A. **The Romance of Nature; or The Flower Seasons Illustrated.** 27 hand-coloured plates. Lovely example of a Victorian Gift Book. 1839.

### Browsers Welcome

Open Monday through Saturday • 735-5546  
2049 West Rittenhouse Square  
(between 20th & 21st, Spruce & Locust)

## Society Hill Beverage

333 Bainbridge - 627-4106

We...ALSO...

Deliver!

Fine selection of Foreign  
&  
Domestic Beers

«» «» «» «» «» «»

Soda • Snacks • Cocktail Mix  
Ice

Cigarettes



Hours: Tues.-Thurs. 10:30-6:30

Fri. - Sat. 10:30-7:00

627-4106

STILTON CHESHIRE FETA CHEDDAR SWISS CHRIS PRE MONDE GREYERE APPENZELLER EMMENTHALER ROHN KASS AGED GOUDA GOUDA SMOKED GOUDA EDAM CREAM HAVARTI MUNSTER DANBO

LINGOT BOURSALT MORBIER PYRENEES DOUX DE MONTAGNE BEAUMONT CHAUMES BUCHERON MOUTRACHET

SAGA BLUE DANISH BLUE JARLSBERG BOURSIN STRING CHEESE MOZZARELLA SMOKED MOZZARELLA MAMSEL

## We're More Than A Cheese Shop! At Society Hill Cheese Shop We Also Carry...

- Imported Coffee Beans (ground to order)
- Coffee Makers and Accessories
- Gourmet Meats, Pates and Salads
- Fresh American and Russian Caviar
- Large Selection of Quiches, Hors d'oeuvres, Entrees, Desserts
- Fresh Fruit, Breads and Cakes
- Imported Biscuits and Crackers
- Gourmet Foods From Around the World

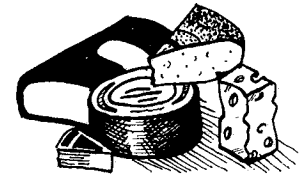

Gift Baskets and Party Trays Custom  
Designed For Your Holiday Needs  
Imported Decorative Biscuit Tins

### SOCIETY HILL CHEESE SHOP

424 So. 2nd St. at New Market / 627-3377



ORDER YOUR  
HOLIDAY  
BASKETS

NOW

BRILLAT SAUVRIN EXPLORATEUR ST. ANDRE SOCIETY BEE ROQUEFORT PORT SALUT GOURMANDISE FONTINA PROVOLONE TALEGGIO GORGONZOLA PECORINA RICOTTA PARMESIANO REGGIANO

---

**HAPPY HOLIDAYS**

# ABNER GREEN

the unREAL ESTATE BROKER

563-2252

**Wednesday Nights**  
**Pasta, Salad, and All That Jazz**  
**\$4<sup>95</sup>**

**salad, pasta, chicken, etc.**  
**jazz by Dick Klein's Fifth Amendment**  
**featuring vocalist Karla Garrison**

**CAFE La SPADA**

618 South Street

923-6480

**Dinner 7—9     Jazz 9—1**

**Ad entitles bearer to 50¢ off dinner**

## Bed & Breakfast Comes to Philadelphia

Beat the high cost of living by sharing your spare room with visitors to our historic city.



Center City Bed & Breakfast wants to register you.  
Call 923-5496 or 735-0881

# BODY COMFORT

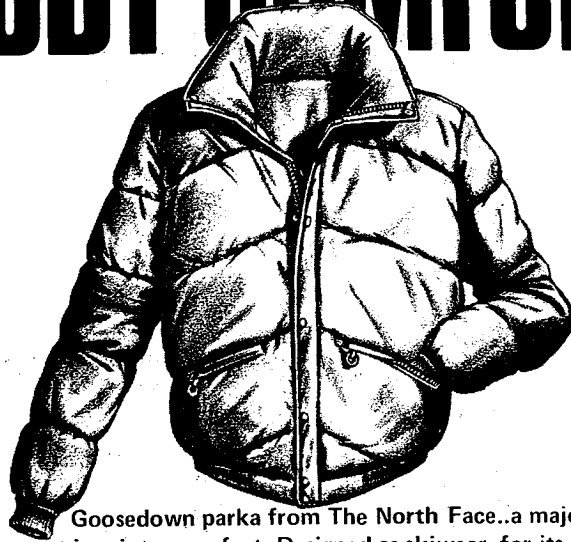

Goosedown parka from The North Face..a major achievement in winter comfort. Designed as skiwear, for its lightness and ease of movement, but anyone who works or plays outdoors will revel in it. Polarnyl shell, with nylon taffeta lining, and altogether a masterful gift. \$145.

## COUNTRY OUTFITTERS

At NewMarket between Pine and Lombard Sts. 928-0774

# Society Hill Realty Company

SPECIALIZING IN SALES AND  
RENTALS OF EXCLUSIVE  
TOWNHOUSES & CONDOMINIUMS

206 S. 3rd St. • 574-9430

## Ornaments Worth Saving At Great Savings!!!

Throughout the year we venture around the world to discover the most unique Christmas ornaments that we can find.

Our collection from over 23 countries is worth saving for years to come, and our prices reflect the values we're known for.

Compare our selection and prices to those you'll find elsewhere, and you'll save enough to help Santa fill your stocking with joy.

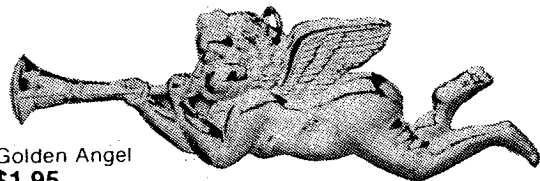

Golden Angel  
\$1.95



Snow Globe  
List up to \$10.00  
P/B \$4.50



Red Satin Heart  
2.50



Chinese Teddy Bear  
List \$3.75 P/B \$1.95



Brass Lanterns  
from India \$1.95

1610 Chestnut, Philadelphia  
NewMarket, Philadelphia  
Suburban Square, Ardmore  
The Marketplace, Cherry Hill NJ

All stores open  
Sundays 12-5

STAY IN TOWN FOR CITY NIGHTS!!!

# THE POTTERY barn

# DARTS & LAURELS

## Here's Looking at You, Santa

Close observers of this periodical may be wondering about the outcome of the first *Resident Newsletter* Fishhouse Punch recipe contest. We salute Sally Thompson who sent in this version of the famous potion.

- 1½ gallons Catawba wine
- ½ gallon rum
- 1½ quarts gin
- 1½ quarts brandy
- 1½ quarts rye whiskey
- 1½ gallons strong tea
- 2½ pounds brown sugar
- ½ pint Benedictine
- juice from 18 oranges
- juice from 18 lemons
- 1 bottle maraschino cherries

Make stock from 36 to 49 hours before time for using. Just prior to serving add one case of champagne.

It should stupefy 50 to 200 innocent wassailers.

- Laurel:** To Gary Aden, Pennsylvania Hospital's able vice president, for effectively convincing hospital personnel that the "one-way" restriction on the 700 block of Delancey Street applies to them, too; and for appreciating how grumpy his neighbors became when they were jolted from their Sunday sleep at 7:30 a.m. by the bombilation of the wrecking ball. Gary, the extra hour-and-a-half you got for us convinced us that Pennsylvania Hospital does have a heart.
- Dart:** To those neighbors who put trash out on a city holiday, when it will not be collected, and *leave it there on the street instead of taking it inside* until the next regular pickup date.
- Laurel:** To the Penn's Landing Square residents on South 2nd St. who, in error, put out their trash on Nov. 11th, but removed it—*everyone* in the two blocks on 2nd St. from Spruce to Pine Sts.
- Laurel:** To Morris Cohen, Society Hill Club's resident piper, for his contribution to the annual children's party; and a Laurel to the Society Hill Club's donation of the pool to the Community Center's day camp three mornings a week last summer.
- Dart:** To the construction-created potholes in front of Hopkinson House, and at the corners of 6th and Pine. Why, when it is obvious that cars could avoid the huge pits if they could go around them, do people insist on parking their cars right next to the holes so that traffic must come to a complete stop before going past?
- Laurel:** To the McCall School principal and staff for maintaining an effective learning climate despite many handicaps created by the public school budget/funding/strike/administrative confusion. And to the McCall School parents who have worked through various groups to keep the public informed of the issues, and who set up alternative schools to keep McCall children together and learning.



## LAUTREC

FINE FRENCH CUISINE

DINNER

Tuesday - Sunday

Sunday Brunch

12 - 3 P.M.

CALL FOR LUNCHEON  
RESERVATIONS

## BORGIA CAFE

Live Jazz  
7 nights

Light Dinners & Snacks

408 S. 2nd Street

923-6660

574-0414

## The Real Estate Edge!

...In Center City Residential

A Residential Division committed to becoming the major force in the center city townhome and condominium market has an edge...especially when it is backed by one of the city's largest, most experienced real estate firms.

- A highly competent professional staff
- Professional service

Call Carl Gersbach when you want to buy or sell a home.

(215) 561-1500

### Jackson-Cross

JACKSON-CROSS COMPANY • REALTORS®  
2000 Market Street, Philadelphia, PA 19103  
PHILADELPHIA • WASHINGTON • WILMINGTON

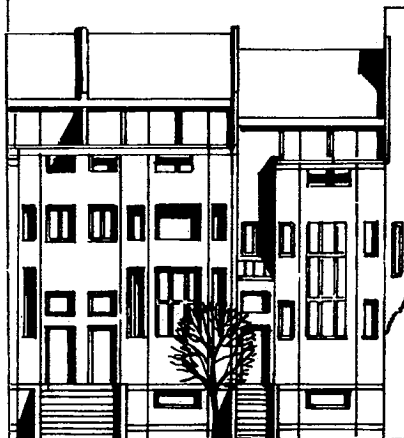

 National Relocation  
Counseling Center

**UNDER NEW  
OWNERSHIP**

# Queen Village Racquetball *and* Fitness Club

*A Full Service Fitness and Recreational Facility*

## "Pre-Opening Specials"

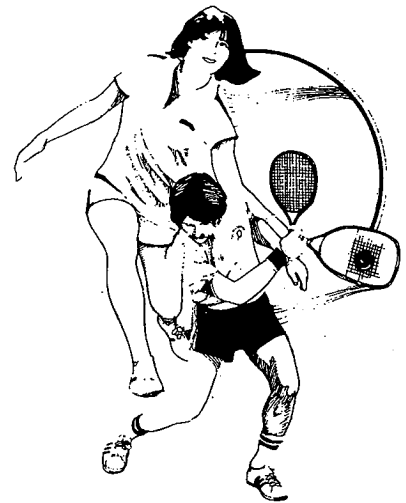

**Racquetball**



**Exercising**

The Club, conveniently located in the Queen Village area of Philadelphia offers a full range of facilities and services for all ages of adults. As one of Philadelphia's finest and largest complexes, the Queen Village Club with its professionally trained staff and modern facilities will strive to meet your needs throughout the year.

### FEATURING

- 10 championship air conditioned racquetball courts
- **No Court Fees**
- Fully equipped and professionally staffed exercise facilities, featuring Nautilus and Universal equipment
- Relaxing lounge overlooking glass backed raquetball courts
- Indoor swimming pool with large co-ed whirlpool
- Roof top private sun deck area and patio
- Carpeted men's and women's locker rooms; each with saunas, day lockers, hair dryers, privacy shower areas
- Rental lockers available
- Towel service available
- Full service pro shop at competitive prices
- Free introductory racquetball clinics
- Snack and light meals available in lounge
- **Very competitive annual fees!**

## "For Fitness, Fun *and* Relaxation"

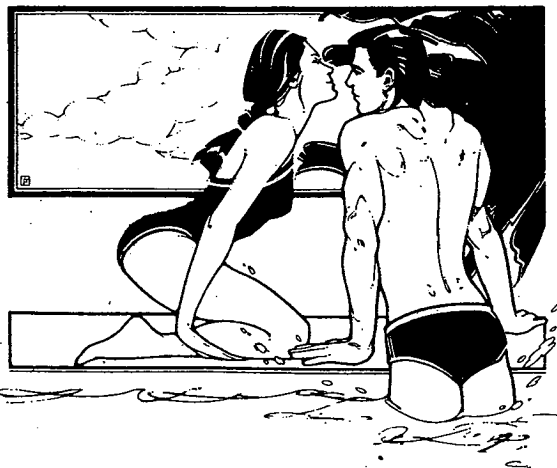

**Swimming**

**Please Stop by Our Sales Office for  
more information and a complimentary  
CUP OF COFFEE**

**Queen Village  
Racquetball and Fitness Club  
325 Bainbridge Street  
Philadelphia, Pa. 19147  
Manager, W. Roscoe**

**922-7900**