

SOCIETY HILL REPORTER

Newsletter of the Society Hill Civic Association
Issued May 8, 1997

That Was Then, This Is Now

"The President's Message" this month comes to you from two former presidents of this Association — Franklin Roberts, who was president in 1966, and David Stevens, who held the office in 1968.

by **David Stevens**

I found in my files the very first issue of *THE RESIDENT*, our Civic Association's earliest predecessor to *THE SOCIETY HILL REPORTER*. It struck me that not much has changed in the 31 years since Frank Roberts outlined the goals of his presidency. To summarize SHCA's objectives, Roberts said:

We will try to:

1. Communicate with members and observers
2. Establish partnerships with City agencies
3. Add to the cultural, educational and artistic life in Society Hill
4. Increase membership and participation.

Roberts asked: "How much can we accomplish in 1966? How much time and specialized experience can YOU contribute?"

In subsequent years SHCA presented a united front in opposing the Crosstown Expressway and the elevated portion of I-95, which would have seriously compromised our community. The organization supported single-family development of existing properties and adherence to parking requirements for all major new developments. It urged the City to put funds into Starr Garden and Seger Playgrounds. Although there was strong local opposition, it favored the arrival of the A&P [now SuperFresh] on 5th Street and the building of subsidized housing at 6th and Pine Streets.

The SHCA has been and still is a forum for considering change. The positions it takes are often opposed by groups of residents. Recent examples are the Hyatt Hotel at Penn's Landing and the cafe at Head House. What worries me is that increasingly I hear, "I don't agree, so I'll drop out." That is counter-productive. If we lose members, we lose an effective forum for considering future changes and we lose clout with the city agencies we deal with. We need more, not less participation.

What Frank Roberts said in 1966 is equally true today. How much can we accomplish in 1997? How much time and specialized experience can YOU contribute?



1966 logo

by **Franklin Roberts**

Our community newsletter, called *THE RESIDENT*, was inaugurated in March of 1966. Here are some excerpts from that very first issue: (Do they sound familiar?)

• • •

The Newsletter will be issued two weeks prior to every Association meeting and will serve as notice for that meeting. The primary objective of the Newsletter is to give background information on subjects that may be discussed at the upcoming meeting. This could include proposed zoning changes, parking problems, plans for new developments, etc. Whatever space is left over will be crammed with committee reports, news from The Redevelopment Authority, people and places in the news, and anything else we stumble across.

• • •

The Newsletter will be distributed to non-member residents in the Society Hill area in order to make them aware of our activities and of our desire to have them join the Association. In addition, copies will be sent to individuals and organizations that are involved with Society Hill.

• • •

Library Committee Report

Mr. William Eiman is in the process of forming a committee to launch an effort to get a branch of the Philadelphia Library located in the area.

— March 1966 newsletter

Library Branch Redux

Our current president, Mel Buckman, has launched an aggressive campaign to get the city to build or install a library branch in our area. Many of us thought was this was an initial effort, because civic association activity had been dormant on this front for several years. Why our previous community efforts failed to gain a library branch we do not understand. Maybe we were not persistent enough. Maybe, over the years, we had more pressing problems to deal with. Does anybody now know or remember?

But the good news is that in the week of April 23rd of this year, the Ogontz neighborhood finally won its campaign to have a Free Library—a dream come true after 18 years of community lobbying. It is also the first library the city has built in 17 years!

It's now our turn! Society Hill and neighboring communities (Queen Village, Old City, Northern Liberties) have waited more than 31 years for a Free Library in our part of the city. Let's give Mel all the committee help he needs to see our dream become a reality.

Let's also be vocal with all the powers-that-be: Call or fax our district Councilman Frank DiCicco (at 686-3458; Fax 686-1931) or write to him at City Hall, Room 488, Philadelphia 19107. Don't forget to contact Mayor Ed Rendell as well as all City Councilmen at Large: Happy Fernandez, Frank Rizzo, W. Thatcher Longstreth, Angel Ortiz, James F. Kenney, Augusta A. Clark and David Cohen.

It's time! We've been patient long enough and there are a number of ideal and unused locations in our neighborhood ready to be transformed into the next Free Library branch. And let's not wait another 31 years!

Wednesday, May 21, 8 pm
Important SHCA Meeting at
Pennsylvania Hospital
8th & Spruce Sts.
See page 3 for details.

Pennsylvania Hospital: Good Hospital, Good Neighbor; But Does It Have a Good Future?



John R. Ball, MD., JD.,
president of
Pennsylvania Hospital,
will speak at the SHCA
meeting at the
Hospital's auditorium
on Wednesday,
May 21, at 8 pm.

Dr. Ball was executive vice-president for clinical services, serving as liaison between the medical staff and administration, when he was asked to assume the responsibilities of departing president Clifford Eldredge.

Last July, he was appointed president and chief executive officer to the hospital by the Board of Managers in a time of wrenching changes in health care and equally dynamic change for institutions delivering that care.

Pennsylvania Hospital is easily the neighborhood's largest employer, providing work for those who live in the community and bringing in thousands of others into the neighborhood every day as employees, patients or visitors.

Three operating units comprise the system: the 505-bed acute care hospital, the Hall-Mercer Community Mental Health Center, and the Institute of Pennsylvania Hospital, a psychiatric care facility in West Philadelphia. Recently, after considering several options, the hospital announced a new affiliation with the University of Pennsylvania Health System.

Dr. Ball is ideally suited to provide guidance through these turbulent times as he has been a senior scholar with the Association of Academic Health Centers in Washington, executive vice-president of the American College of Physicians, associate executive vice-president for Health and Public Policy for the American College, and former senior policy analyst in the White House Office of Science and Technology. A graduate of Emory University, Dr. Ball received his MD and JD degrees from Duke University in 1972.

Please join us to hear his thoughts on the future of health care, the implications of the hospital's realignment for our community, and the status of the hospital ten-months into his "watch."

Also at the May 21st meeting: The Foundation for Architecture will give us a presentation of its Walk!Philadelphia Sign Project throughout the City. This pedestrian way-finding system of signs has been installed in Center City and will soon be followed by signs in the Parkway Museums area. The signs, featuring each area's major attractions, will soon come to our Historic District. Hear more about this program at the meeting.

Contributions Over & Above!

The following good neighbors have sent our Association generous contributions during the period from October 1996 through April 1997. These contributions are in addition to their 1997 annual dues.

We thank each and every one:

Michael Ayjian	Fran & Allen Kirschner
Carol & James Baldwin	Dr. & Mrs. Charles Knecht
Lu & Charles Bangert	Harold E. Kahn
Salvatore J. Barbuto	Bonnie & Mel Korn
Judy & Ernie Barrett	Marian Locks
Penelope & George Batcheler	Jenny & Peter Marziano
Helen & Jack Bershad	Anne & George Nofer
Richard Bost	Linda & John Percival
Janice Bredt & Ted Schwartz	Patricia & Russell Redenbaugh
Debbie & Alan Casnoff	Mary & Robert Reinecke
June & Don Castell	Mr. & Mrs. Donald H. Roberts, Jr.
Harriet Howard Cortez	Tillie Rideout
& Ricardo Cortez	Ruth & Marvin Sachs
Albert J. Crawford, Jr.	David Seltzer
Mr. & Mrs. F. Galashian	Mr. & Mrs. Bernard Shuman
Sheryl & Philip Gilman	Dorothy & David Stevens
Scheryl & Richard Glanton	Sonja & Dick Vent
Dr. & Mrs. Milton Kitei	Francine & Douglas Verney



SHCA's 1997-1998 Electoral Slate

Elections for new officers and directors will be held at the Wednesday, May 21, General Membership Meeting at Pennsylvania Hospital. The SHCA Board of Directors has accepted the following candidates from the Nominating Committee:

<i>President:</i>	Mel Buckman (incumbent)
<i>Vice Presidents:</i>	Bernice Hamel (incumbent) Howard Lander (incumbent) Mary Sturdivant
<i>Treasurer:</i>	Perry Whyte
<i>Secretary:</i>	Janet Cooke (incumbent)
<i>Northeast Quadrant:</i>	Norman Tissian
<i>Northwest Quadrant:</i>	Jane Stevenson Anna Marie Marshall
<i>Southeast Quadrant:</i>	Deborah Robinson Joy Lindy (incumbent)
<i>Southwest Quadrant:</i>	Richard Bost

Each SHCA member was sent the procedure for nominating individuals, including provisions for submitting nominations by petition.

Sincere thanks go to departing Vice President Lorna Katz Lawson, who tirelessly and devotedly chaired the Zoning Committee, and Treasurer Martha Moore for handling all the income and disbursements, as well as preparing the monthly financial reports. Martha also chaired the Nominating Committee.

**Your Neighborhood
Real Estate Broker With
75 years of Service
To The Community
Specializing in:**

- Residential Sales
- Property Management/Rentals
 - Investments
 - Commercial
 - Relocation

**A Trained Staff of Agents with
a Commitment to Service**

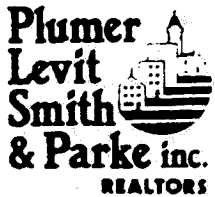

**922-4200
226 South St.**

MARK YOUR CALENDARS

Sunday, May 18

RAISING DOUGH FOR NEIGHBORS DAY
Baker Street Bakery
Benefits Society Hill
See page 4

Wednesday, May 21

GENERAL MEMBERSHIP MEETING
At Pennsylvania Hospital's Auditorium
800 Spruce Street
Election of New SHCA Directors
Speaker: John Ball, MD, JD.
President, Pennsylvania Hospital
Topic: Implications for Our Community:
The Hospital's Affiliation with HUP
6:30 pm Board of Directors
7:30 pm Refreshments
8:00 pm Program (See page 2)

Saturday, June 7

TRIP TO MARYLAND'S EASTERN SHORE
Benefits Historic St. Peter's Preservation
For more information, see page 5

Wednesday, June 18, 7:30 pm

BOARD OF DIRECTORS MEETING
Old Pine Community Center
4th & Lombard Streets

**Sundays, Memorial Day Weekend
through September 28, 1 - 3 PM**

FREE CHILDREN'S CRAFT WORKSHOP
at Head House, Sponsored by
Creative Collective for Children 3 to 10
Call 790-0782 for information.

ΦITNESSΣ (Is it Greek to You?)

**LOSE WEIGHT
PREVENT BONE LOSS
IMPROVE CARDIOVASCULAR FITNESS
INCREASE STRENGTH and FLEXIBILITY**

.. and DO IT IN YOUR OWN HOME

RICHARD M. GIBSON

Certified Personal Trainer - References Available

923-6435 SPECIALIZING IN ADULT FITNESS

SOCIETY HILL REPORTER

Society Hill Civic Association
P.O. Box 3, Philadelphia, PA 19105
(215) 629-1288

EDITORS

Bernice Hamel & Mary Sturdivant

CONTRIBUTORS

Janet Cooke • William Hawkins

Joan Less • Lawrence Meehan

David Stevens

BUSINESS AND ADVERTISING

William Hawkins

For inquiries about advertising
call Bill at 592-8734.

GRAPHIC DESIGN

Norman Kline

CONTRIBUTIONS WELCOMED

Deadline: June 15

Mail contributions to above address

Fax to (215) 925-0877

or E-mail to: hamelbt@aol.com

BULLETIN BOARD

Up, Down, And Back Around Cafe at the Shambles:

On April 16, the Pennsylvania Liquor Control Board informed the Dickens Inn that they did not meet the requirements of Code 408.11 (a very special, temporary seasonal application) because they were not selected and certified by the city, and because the proposed size of the cafe was considerably smaller than required.

On April 21, Michael Harwood of the Dickens Inn sent a letter to SHCA thanking SHCA Board members who supported the proposed project, but basically informing them that he was throwing in the towel on the project.

Then a phone call two days before going to press (April 26) from Wayne Spilove, one of the principals in the proposed cafe, revealed that the cafe was once again likely to move forward for this spring and summer season. Hopefully, there will be some definite news by the May 31 General Membership Meeting.

Fallout From Shootout at Head House

Alan Halpern has resigned as an editor of this newsletter over his disagreement with the decision by the Board of the Civic Association to support the plan to establish a cafe at Head House during the summer. We will miss him greatly and thank him for his years of leadership and the superb writing skills and acerbic humor he contributed to our publication. THE REPORTER will go on, and we are hereby appealing for all interested, experienced or fledgling writers to help us.

Stop in. Stock up. Join the fun.



Raising Dough for Neighbors Day

On Sunday May 18 our neighborhood bakery, Baker Street, will donate proceeds from the day's bread sales to the Society Hill Civic Association. Baker Street is one of the best bakeries in town, and we are so lucky they moved to 5th Street, opposite the SuperFresh. (Last year Baker Street conducted a similar sale, and SHCA instantly became \$1,000 richer!) Support our good neighbor. Stock up and enjoy!

More Poop On Carriage Horses

The Mayor's Animal Advisory Committee is reviewing the current regulations for the carriage horse trade. Currently, horses can be worked in 94-degree heat with no consideration about humidity. Rumor has it that the three horse carriage companies would like to grandfather the existing rules and regulations, thereby creating their own monopoly by eliminating competition. Any comments or suggestions, please contact William Hawkins at 592-8734.

BREAD ALERT!

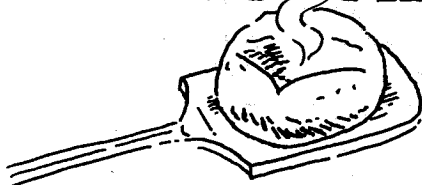

Don't miss these Limited Edition Loaves for May and June:

May Bread of the Month

Herbed Ciabatta

Airy textured, slipper-shaped loaf enriched with olive oil and milk. The perfect partner for pasta.

June Bread of the Month

Fruited Hazelnut

Naturally sweet with the season's ripest fruits.
For breakfast, brunch...or anytime!



ARTISAN BREADS

316 S. 5th Street • Society Hill

Pastries • Sandwiches • Cappuccino Drinks

OPEN 7 DAYS

Appraisals

Complete Fine Arts and Household
Appraisal Service for Insurance,
Estate Liquidation, Sales and Gifts.
Flat Rates.

For Information Please Call 242-0375

CHANDLEE & BEWICK

7811 Germantown Ave., Chestnut Hill
Philadelphia 19118

WM. H. CHANDLEE III

*Member of The Appraisers Association
of America*

•NEW OWNERS •NEW SERVICES •NEW APPROACH

Society Hill Realty Company, Inc.

206 South 3rd Street • Philadelphia, PA 19106

215.925.9403 • Fax 215.925.9661

THE PERSONAL SERVICE PROFESSIONALS
WHO OFFER YOU:

FULL SERVICE BROKERAGE
BUYER AGENCY
PROPERTY MANAGEMENT

PROPERTY MAINTENANCE-WHOLE HOUSE/ RENTAL UNITS
(By:Facilities Management Services)

TENANT SERVICES AVAILABLE LANDLORD SERVICES

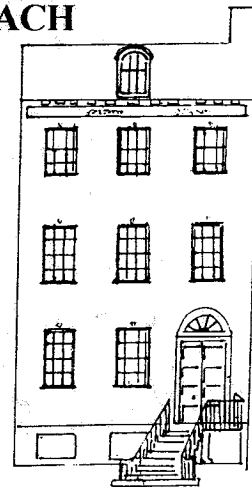

Benefit St. Peter's Preservation Corporation Day-Trip to Chesapeake Bay: Saturday, June 7

St. Peter's Church, a National Historical Landmark in our community, is sponsoring a day trip to the eastern shore of Maryland. Famous for its early history, scenic land and water views, and homes and gardens, the Chesapeake Bay has ties to Philadelphia's Lloyd and Cadwalader families and their Episcopal and Quaker backgrounds. This tour links colonial Philadelphia/Society Hill history to interesting locations along the Chesapeake Bay.

Travelers will visit a working mill, a historic church and several stately private homes, including Wye House, where Elizabeth Lloyd Cadwalader was raised prior to marrying John Cadwalader and moving to 2nd and Spruce Streets. Her carved marble tomb stands in St. Peter's churchyard.

Departure will be from St. Peter's Church, at 3rd & Lombard Streets, at 8:30 am. Cars can be parked in the school lot for the day. A deluxe coach will transport the group, and lunch will be served in the riverside village of Chestertown.

The cost per person (transportation, admissions, lunch & refreshments) for members of Historic St. Peter's Preservation Corporation is \$75, and this includes a \$25 tax-deductible contribution. For all others, the cost per person is \$100, and this includes one-year membership in the Preservation Corporation, with a \$50 tax-deductible donation. Questions? Phone Jo Ann Buller at 625-8585 or 925-4784, or mail your reservation check to her at 241 Delancey Street, Philadelphia, PA 19106.

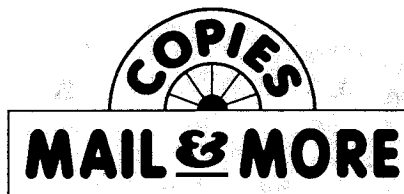

Everything You Need In One Store

- Copies** Color Laser; Black & White; Transparencies; High Volume
- Mail** UPS/FedEx; Postal Services/Stamps; Custom packaging & Supplies; Private Mailboxes.
- & More** Faxes (send & receive); Binding and Laminating; Business Cards; Greeting Cards; Phone Cards; Notary; Lottery Tickets

Mon.-Fri. 8a.m.-8p.m.; Sat. 9a.m.-4p.m.
Tel: 467.3333 Fax: 467.3332

Major credit cards accepted

842 South 2nd Street
Philadelphia 19147



At The Chef's Market,
weddings & other
festive occasions are a...
Piece Of Cake



Open every day of the year



Phone 925-8360

Fax 925-8907



The Chef's Market • 231 South Street • Philadelphia, PA 19147

A SECOND GENERATION MOVING COMPANY

**HANK'S
MOVING CO.**

(215) 587-9617
(215) 665-0390
e-mail hank@hanksmoving.com



ANYWHERE - ANY TIME LOCAL - LONG DISTANCE

- APARTMENTS
- OFFICES
- HOMES
- FREE ESTIMATES
- FULLY INSURED
- 7 DAYS A WEEK

"QUALITY WORK BY TRAINED PROFESSIONALS"
OVER 7000 SATISFIED CUSTOMERS



The Coché Center
(215)735-1908
(215)735-4741 FAX

A Practice in Clinical Psychology

Judith Coché, Ph.D., A.B.P.P.
Director

The Rittenhouse, 210 West Rittenhouse Square
Suite 404, Philadelphia, PA 19103

Now Open To The Public

Now Open To The Public



Founded in 1897

Now Open To The Public

For Business & Social Events

215-925-2040

150 S. Independence Mall West
SW Corner of 6th & Chestnut Sts., Phila., PA 19106

NICK MELI, JR.

**General Contractor.
Apartment/Condominium
Maintenance.**

Quality Work - Competitive Prices
Fully Insured

****Electrical **Plumbing
**Carpentry **Painting
** Interior & Exterior Renovations**

Call for free estimate

(215) 342-9961

Urgent On-Line Web Site Calendar Needed

Is there anyone in the community willing and able to volunteer to create an SHCA home page?

We need an on-line calendar so people can receive timely information.

A serious communications problem has been identified that new technology can address.

Is there anyone in the community willing to volunteer his or her expertise to create for us an "On-Line Calendar" so people can know what is going to happen or receive timely information about what has already happened? We'll be standing by the phone (925-4363). Or, better yet, use our e-mail address if you want to volunteer: hamelbt@aol.com.

Here's the problem:

Several times each month, meetings and hearings are scheduled about which the population at large should be made aware. THE REPORTER cannot handle these notifications on a timely basis.

This newsletter is scheduled to come out one week prior to our four General Membership Meetings with two additional issues. Our volunteer staff needs several days to assemble the various materials and to write and edit. The layout designer and printer each need a week. Then there is hand and mail delivery. In all, over three weeks elapse from the closing deadline to its appearance in your mailbox. Moreover, two months of information must be covered in each issue.

For example, in this issue, neighbors protesting a new construction on Philip Street distributed a flyer one day before our deadline concerning a hearing at the Historical Commission. Our untimely publishing schedule meant we could not inform anyone who might want to attend this April 29th meeting, nor could we report the results of the hearing — even though it would be "old news" by the time THE REPORTER hit the streets.

Another example is a notice, dated April 21, for a public hearing on May 6 concerning the proposed 20-year renewal of the South Street/Headhouse District! Now almost everyone who lives here has strong feelings pro and con about South Street and its destiny.

Again, our publishing schedule was too late to notify people to attend the hearing or report the results.

Phila Deli

- delicatessen
- restaurant
- informal catering
- box lunches

410 412 SOUTH ST. PHILA. PA 19147-1535
215-923-1986 FAX 215-923-2299

LAMP SHADES FACTORY DIRECT

OPEN TO THE PUBLIC • ALL WORK DONE ON PREMISES • 15000 FRAMES IN STOCK

- CUSTOM SHADES
- RECOVERS EXPERTLY DONE
- ANY SHADE COLOR OR SIZE

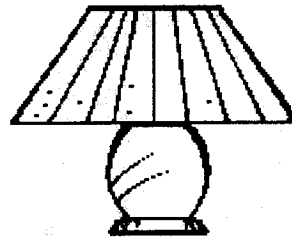

- READY MADE SHADES
- SHOP AT HOME (we will come to your home or apartment)
- DECORATORS WELCOME

ALGA LAMP SHADES

325 N. 13TH ST. • PHILA. PA (13th AND VINE)
215-922-7746 OPEN MON-FRI 7AM-4PM
OR BY APPOINTMENT

DON'T BE MISLED OR MISFED.

There's only one world famous steak & seafood restaurant in Philadelphia. Only one restaurant where your hosts, the Taxin family, will make you feel like a big fish. For a lunch or dinner that will go down in history, don't miss visiting Philadelphia's only landmark restaurant in old city, not center city.

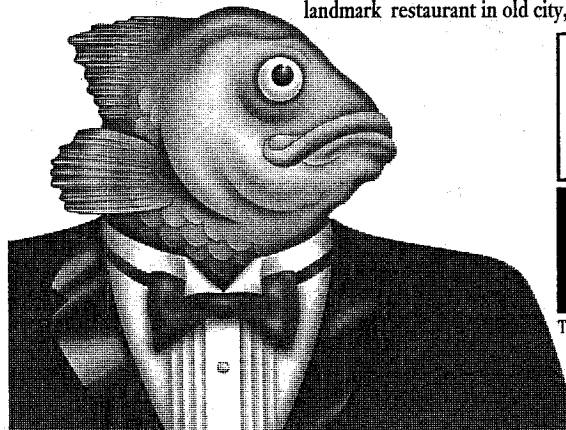

10% OFF

Food portion of check when you present this ad

THE OLD ORIGINAL
BOOKBINDER'S

The World Famous Restaurant Down By The River

2ND & WALNUT STREETS • 925.7027 • VALET PARKING (FREE AT LUNCH) • MAJOR CREDIT CARDS ACCEPTED



Laurels



BILL GATES LAUREL to Kate and Mark Wilcox and Celeste and Michael Ayjian of the 400 block of Spruce Street — because nobody does Windows better.

Each holiday these neighbors outdo each other in whimsical and beautiful thematic window box displays — inviting tourists and neighbors to rubberneck in the most delightful way. Guard this laurel, competition is coming on strong from the 300 block of Spruce!

FLORAL LAURELS to all those neighbors who adorned Franklin Lamps with bodacious baskets. Special thanks to Gail Hearn and Cherry Bombeck for organizing the sale of baskets. If you still want some hanging flower baskets, contact the Physick House at 925-7866 (or create your own).

MORE LAURELS to the neighbors on the 200 block of Delancey for their beautiful tulip display, and the 500 block of Pine for the blooms starting in early, early spring and continuing, we expect, all summer long.

THE CREATIVE COLLECTIVE CRAFTS & FINE ARTS FAIR

*Memorial Day Weekend
May 24th, 25th, 26th*

*2nd & Pine Sts., Phila.
Historic Headhouse Square*

Sat. 12 NOON - 11 PM

Sun. 12 NOON - 10 PM

Mon. 12 NOON - 6 PM

*Free Children's Workshop Sun. 1-3
information 215-790-0782*

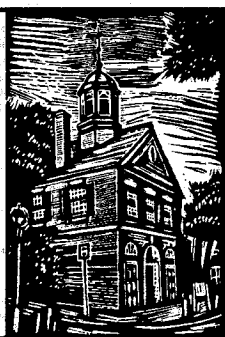

DENISE BARON
(215)629-9098
(215)413-7710 FAX
20 N. 3RD STREET
PHILADELPHIA, PA
19106



SHOPPING
ORGANIZING
BOOKKEEPING
CLEANING
ERRANDS
ETC.

FOR ALL THOSE THINGS YOU CAN'T FIND TIME TO DO

COMPUTER TUTOR

Thinking of getting a computer, but not sure what's right for you?
Just got a computer, but not sure what to do with it?
Tired of waiting on help lines to get answers to simple questions and problems?
Intimidated by technobabble?

HELP IS AVAILABLE!

Tutoring and consulting on all aspects of personal computer usage including word processing, e-mail and the Internet. Specializing in novices and mature users.

One to one instruction in your home on your computer.

Reasonable rates.
Satisfaction guaranteed.
Walter Pauls
215-925-5104

Society Hill Synagogue's ANNUAL SPRING FAIR

*Sunday, May 18, 1997
10:00 am - 3:00 pm*

*Games for Kids of All Ages
Distinctive Handmade Crafts
Silent Auction
Restaurant Raffle
Stump the Rabbi
Food
Flea Market*

**Plan to attend the Annual Spring Fair
and bring your entire family!**

*For more information, contact:
Society Hill Synagogue
418 Spruce Street
Philadelphia, PA 19106
215-922-6590*

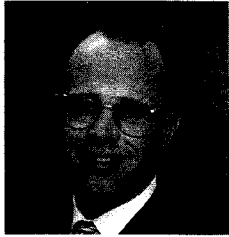

MIKE McCANN

"The Real Estate Man"
Turns "For Sale" to
SOLD!

★★★★★

Mike McCann is pleased to be appointed
exclusive agent for the impeccably restored
BOOKER BINNEY HOUSE,

located at 240 S. 3rd Street! This home boasts
13ft ceilings, pine floors, original details, flexible
living arrangements. It is offered at \$950,000.
Please call 440-8345 for a detailed brochure
and personal tour of this 1829 era home.

★★★★★

JUST SOLD:

710 Pine St - SOLD in 7 Days! \$225,000
222 Delancey St- SOLD in 45 Days! \$339,900
504 Addison Ct- SOLD in 21 Days! \$289,900
205 Delancey St- SOLD in 10 Days! \$299,900

★★★★★

NEW LISTINGS:

345 S. 5th- Newer construction! Contemporary
5 bdrm, 3.5 bath, den, garage, deck, \$439,900
112 Lombard- Newer construction, 3 bdrm, den,
2.5 bath, garage, c/a, h/w floors \$279,000
304 Lombard #2- 2 bdrm plus loft, 2 bath, 2
f/ps, courtyard entry, h/w floors \$119,900
304 Lombard #1- 3 bdrm, 2 bath, den, roof
deck, h/w floors, courtyard entry \$145,000
627 Pine- REDUCED! 3-4 bdrm, 2.5 baths,
office, 3 f/p, c/a, roof deck, h/w flrs \$345,000

★★★★★

For all your real estate needs

CALL MIKE McCANN

and his 5 star team!

PRUDENTIAL PREFERRED

414 Walnut Street, Phila, PA 19106

215-627-6005 ★ 215-440-8345

Membership drive stalled at 600 Sidewalk Sweep To End?

The SHCA membership drive for 1997 has stalled at 600—right about where we ended up in 1996! The financing plan for the once-a-week sidewalk sweep by the Center City District staff was based on \$10 from the first 600 members (\$6,000) and then all \$40 from the next 200 members (\$8,000). **This program will cease at the end of May unless we raise more money.** In other words, 200 more memberships are needed right now to keep this program alive. There are several ways you can help:

1. Persuade your friends and neighbors to join SHCA now (4 out of 5 home owners and apartment dwellers do **not** belong—so start asking).
2. Make a tax-deductible contribution to The Society Hill Fund. The Fund will pay for two month's worth of sweeping (\$2,400) if the residents match this with \$2,400 or more. Twenty-four people giving \$100 or 48 giving \$50 will provide four months of sweeping.
3. Your business could sponsor a month of sweeping for \$1,200, and you would be publicly thanked in the next issue of THE REPORTER.

TOGETHER we can keep this program alive! Please make your tax-deductible donation to The Society Hill Fund and mail or deliver to: David Stevens, 116 Delancey Street, Phila., PA 19106.

What! You haven't yet joined for 1997?

This is YOUR Civic Association, an example of democracy at work. We may not always agree with each other—in fact, we often disagree. But on one point we are unanimous: We love our community and want to see it continue to thrive as the unique urban center of vitality that it has been since Society Hill was "redeveloped" in the late 1950s.

If you want our sidewalk sweep program to be continued, send in your 1997 dues immediately!

Name _____

Address _____ Zip Code _____

W Phone _____ H Phone _____

- New Renewal
- Household Membership \$40
 Business & Organization Membership \$80
 Additional Contribution \$ _____

I (We) would like to work on the following committees:

- | | |
|---|--|
| <input type="checkbox"/> Clean-Up Day | <input type="checkbox"/> Riverboat Gambling |
| <input type="checkbox"/> Historic Preservation | <input type="checkbox"/> Society Hill Reporter |
| <input type="checkbox"/> Homeless Intervention | <input type="checkbox"/> Town Watch |
| <input type="checkbox"/> Legislative/Liquor Control | <input type="checkbox"/> Tree Tenders |
| <input type="checkbox"/> Membership | <input type="checkbox"/> Zoning & Development |

YOUR HOME IS YOUR PRIMARY INVESTMENT. PROTECT IT!

**MAKE YOUR CHECK PAYABLE TO
Society Hill Civic Association
P.O. Box 3, Philadelphia, PA 19105
Phone & Fax: 629-1288**

Clean-Up Day

Saturday, May 3rd, was the ninth Clean-Up Day involving the great semi-annual car migration! We thank new Co-chairs Jim Covello and Janet Cooke for taking on this humongous task. They, in turn, thank the Parking Authority, the Streets Department, the Sixth Police District, Pennsylvania Hospital, the National Park Service, Waste Management Corporation, the Citizens Alliance for Better Neighborhoods, SuperFresh, and the Plant Sale Committees of Physick House and the McCall School.

Thanks also to all the participating South Street restaurants who fed our hard-working neighbors who came out with their brooms and blooms to help make Society Hill sparkle!

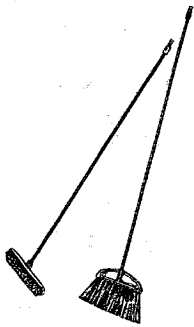

of Change,” and Will O’Brien, Project H.O.M.E., for sharing Patricia’s story with us.

Sister Mary Scullion, director of Project H.O.M.E. and Will O’Brien, also of Project H.O.M.E., have been a source of knowledge, support and friendship to our community’s committee members.

Their organization, as well as other ones in the city can always benefit from volunteers or donations of furniture, utensils, clothes, etc.

Please call Committee Chair Joan Less if you want to know more about how YOU can help: 625-9849. (If you misplace her number, just call the SHCA office at 629-1288 and leave a message which will be forwarded.)

Patricia’s story demonstrates that with a combination of empathy and the right services, we can make a difference towards helping the homeless in Society Hill.

Homeless Intervention

Patricia is a lovely middle-aged woman, well-groomed, attractive and clearly a woman of some accomplishment. Beginning last spring or summer and through several months this past winter, she lived on the steps of the PSFS building at Washington Square (just opposite Pileggi’s Salon, an advertiser in this newsletter). Because she does not look like a typical street-person, many people were surprised by her situation.

Patricia managed to survive, in spite of no money and no trust in the system, because several people took an interest in her—including staff and clients from Pileggi’s, as well as other nearby shops and offices. An office-worker confided to Patricia that she empathized with Patricia’s plight, as she herself was only one paycheck away from paying the rent.

Jean Bodine, a long-time Society Hill resident and Committee Chair of our “Project Street Trees” is one of the people who took an interest in Patricia. Jean recalled that one day, while weeding and caring for a tree in the Tree Tenders program at 7th and Walnut, Patricia approached and offered to help. As they worked together, Jean asked Patricia if she lived in the neighborhood. Patricia said she did and pointed to the steps. After that, Jean would often stop and talk with Patricia and Patricia regularly helped her tend other trees in our community.

Jean introduced Patricia to Sister Mary Scullion, director of Project H.O.M.E. Thanks to Jean Bodine and Sister Mary Scullion, Patricia was eventually moved into “Women of Change” a new residence for women living on the streets.

Special thanks to Mary Paul Cancienne, “Women

Historic Preservation

The Barclay House, built circa 1750-1758 — you may know it as the house with a Japanese garden.

The new owner at 217 Delancey Street, at the corner of Philip Street, has petitioned the Architectural Committee of Philadelphia’s Historical Commission to allow the demolition of an existing two-car garage, built in the early 1960s. Though not a historical structure, the existing garage on Philip Street was designed in close architectural harmony with the original colonial house and other buildings on Philip Street. The new owner wishes to construct in its stead a 23-foot-wide garage, with a 21-foot-wide door fronting Philip Street, which could accommodate as many as three cars.

Nearby neighbors of the 300 block of Philip Street oppose this construction. The SHCA’s Historic Preservation Committee supports the position of our Philip and Delancey Street neighbors—because the proposed garage would be out-of-scale with the existing streetscape where homes average 16 feet widths on this very narrow, cobblestone street.

At an initial hearing of the city’s Architectural Committee of the Historical Commission, preliminary plans to increase the scale of the windows of the house that face Delancey Street were approved, as these changes, according to the Committee, do not violate historic standards(!). Another hearing, on April 29th, cannot be reported about in this issue of the newsletter. See why in the article about our need for a timely SHCA Calendar Web Site on page 7. We’ll try to keep you informed.

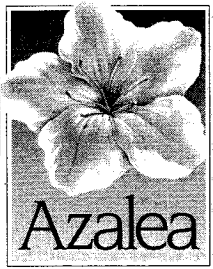

SUNDAY BRUNCH

Relax and enjoy a spectacular Sunday Brunch at our award-winning Azalea Restaurant.

Begin with an assortment of international cheeses, select fresh fruit and berries. Our smoked Norwegian salmon, whitefish salad and an assortment of freshly baked breads are outstanding. Or, select a three-egg omelette prepared specifically to your order by our attending chef. Azalea always features regional foods—Lancaster Brand breakfast meats and local seasonal vegetables. Top it all off with a tempting selection of pastries, cakes and tarts from our distinctive Dessert Buffet.

In addition, Azalea offers an À La Carte Brunch menu, which includes the full Buffet and your entree selection.

The Omni Dining Experience...Your Deserve It!

Brunch Buffet \$21.95
Served from 11:00AM to 2:00PM

OMNI HOTEL
AT INDEPENDENCE PARK
401 Chestnut Street • Philadelphia, PA 19106
215-925-0000

The Omni Hotel at Independence Park is owned and operated by Independence Square Management Corporation under a license agreement issued by Omni Hotels Franchising Corporation.

TRAVEL ANYWHERE

Society Hill Towers Plaza
257 Saint James Place
Philadelphia, PA 19106

API Member
The Nation's Premier Travel Consultants™

215-923-4300 • 800-523-1650
Monday - Friday 9-6 • Saturday 11-3 pm



Experience Counts!

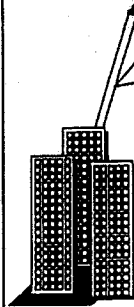

Quality Travel Services
for
29 years

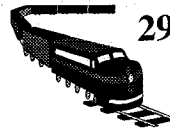

Words of Wisdom

“The Idea of what is true Merit, should also be often presented to Youth...as consisting in an Inclination join'd with an Ability to serve Mankind, one's Country, Friends and Family: which Ability...should indeed be the great Aim and End of all Learning.”

— Benjamin Franklin

Summit on Volunteerism

This newsletter was assembled as the Presidents' Summit on Volunteerism commenced. The University of Pennsylvania is working with communities to develop stronger relationships, ones that will help Philadelphia retain more of the valuable young citizens they educate. To learn more about volunteer service opportunities, visit Penn's Web site:

<http://www.upenn.edu/ccp/>

LAW OFFICES of DAVID L. PALLETT

Professional Representation

- Serious Injuries
- Criminal Defense

790-1444

1420 Walnut Street, Suite 1100
Philadelphia 19102

PIANO LESSONS WITH BETSY ALEXANDER

- ♫ RECOGNIZED TEACHER & COMPOSER
WITH MUSIC CONSERVATORY DEGREE
- ♫ PROVEN MOTIVATOR OF STUDENTS OF ALL AGES
- ♫ VARIED METHODS TO BEST SUIT EACH STUDENT
- ♫ BEAUTIFUL SOCIETY HILL PIANO STUDIO
- ♫ UNUSUAL OPPORTUNITY TO LEARN
FROM A WORKING COMPOSER
- ♫ FRIENDLY PARAKEET, GREAT STICKERS,
FUN LEARNING ENVIRONMENT

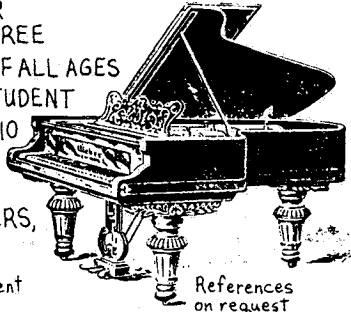

References
on request

For a free evaluation & interview appointment
call **627-7664**

R. CHOBERT PAINTING & PAPERHANGING

833 S 2ND ST PHILA

MAY WE
BRING SOME
COLOR
INTO
YOUR LIFE ?



(215) 389-7788

CREATING BEAUTY SINCE 1967



Rita Roy does more
than just open doors...

She **SELLS**.

Nobody does it better
in **SOCIETY HILL**

So...Call Rita

(215) 587-6931

(215) 627-7987

Jackson-Cross

Dileggi

ON THE SQUARE



TOTAL CARE
 HAIR
 BODY
 FASHION
 ACCESSORIES
 AND
 SHOES

715-717 WALNUT ST, PHILADELPHIA

SALONS 627-0565
 BOUTIQUE 922-3526
 SHOES 829-9292

Coming...New Signs for Head House

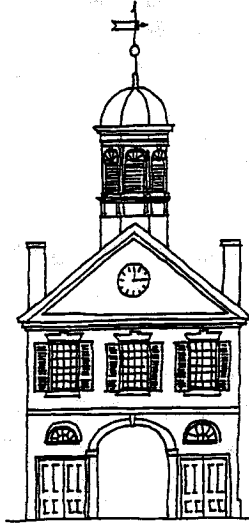

If you've walked past the Head House and Shambles lately, you would have noticed the aging and decrepit signs, one at Pine Street and the other at Lombard Street, installed at the time of the Bicentennial celebrations. They are now suitable for the trash heap, especially since a recent rash of graffiti has made them impossible to read.

The Head House Conservancy will be installing new free-standing signs at this historic site in conjunction with a new signage program for Old Philadelphia Congregations, a consortium of historic houses of worship in our area. These signs will be designed by Joel Katz De-

sign Associates, the firm that installed the original signs 20 years ago. They will utilize the most up-to-date technology to resist graffiti and remain attractive for many years.

The new signs should be ready for installation sometime in the fall. The Conservancy is emptying its treasury in order to fabricate these two-sided signs, one at Pine Street in front of the Head House and the other at Lombard Street.

Each sign will face two directions (similar to the existing signs) and one side will tell the story of Head House and the Old Second Street Market while the other side will tell the history of either Society Hill (Pine Street sign) or of Queen Village (Lombard Street sign).

Both the Society Hill Civic Association and Queen Village Neighbors have committed to pay the design fee for creating the graphics that relate to their communities, while The Head House Conservancy will pay the design fee for Head House and the Old Second Street Market signs plus all fabrication and installation costs for both signs — approximately \$10,000.

The copy for "Welcome to Society Hill" and "New Market and Head House" were written by Penelope Batcheler and Bernice Hamel, with Matt DeJulio's editorial suggestions. The "Welcome to Queen Village" copy was written by Colleen Puckett, vice president of the Queen Village Neighborhood Association.

DENISE BARON

(215)629-9098

(215)413-7710 FAX

20 N. 3RD STREET

PHILADELPHIA, PA

19106



SHOPPING

ORGANIZING

BOOKKEEPING

CLEANING

ERRANDS

ETC.

FOR ALL THOSE THINGS YOU CAN'T FIND TIME TO DO



MIDTOWN



AVAILABLE FOR SALE IN SOCIETY HILL!

307 S. 3rd Fab large historic home, double LR, gdn, fps!!	\$775,000.
426 Pine Wonderful 4BR, sep living quarters, 2c GARAGE	\$539,000.
274 S. 3rd Orig features, hi ceil, beaut fps, Libr, nice gdn	\$495,000.
402 S. Front Contemp 3BR, 3.5b, gdn, deck, 2 car PKG avail	\$395,000.
504 Delancey Newly renov 4BR, fps, gdn, breakfst rm	\$360,000.
432 Pine Exquisite 4BR, 2.5b. Newly renovated, 2 car PKG	\$345,000
324 Lombard Historic 4BR, 1.5b, 4fp, c/a, orig dtls	\$299,000.
500 Addison Ct 3BR, 2.5b, 2 decks, gdn, GARAGE	\$299,000.
237 Spruce Fab location, 4br, 2.5b, great gdn, PKG	\$279,000.
131 Pine Street Location! 3BR, 2.5 baths, garden, deck	\$250,000.
525 1/2 Spruce New! Beaut bi-lev, 2BR, 2b, den, new kit	\$175,000.
535 Delancey Location, Location! Shell w/garden	\$169,900.
636 Panama New! Fab 2BR, 1.5b carriage hse, fp, gdn	\$139,000.
Hopkinson House 1BR, Square view, balcony, PKG avail	\$77,000.

SOLD in SOCIETY HILL! 1996 and thru 4/18/97:

(Midtown has participated in the sale of each-either Listed, Sold, or Listed and Sold)

504 Addison Court	102 Lombard Street	502 Addison Court	267 St. Joseph's Way
512 Addison Street	237 Pine Street	500 Pine Street	236 S. 3rd Street
644 Pine Street	502 Pine Street	507 Delancey Street	439 Gaskill Street
247 St. Joseph's Way	521 A Randolph Ct	Pier 3, #330	501 S. Hancock Court
255 St. Joseph's Way	518 S. Randolph Ct	510 Delancey Street	Soc Hill Towers, #9F
269 St. Joseph's Way	Soc Hill Towers, #18A	536 Delancey Street	Soc Hill Towers, #18H
269 St. Joseph's Way	Soc Hill Towers, #2E	127 Locust Street	130 Locust Street
269 St. Joseph's Way	261 Spruce Street	241 Locust Street	511 Locust Street
269 St. Joseph's Way	515 Spruce Street	222 Delancey Street	235 Spruce Street
269 St. Joseph's Way	308 Spruce Street	Hopkinson House, #817	315 Spruce Street
269 St. Joseph's Way	912 Spruce Street	441 Gaskill Street	1 Willings Alley
269 St. Joseph's Way	413 Spruce Street, #6	226 Locust Street	330 S. 3rd Street
269 St. Joseph's Way	627 Spruce Street	234 Locust Street	Soc Hill Towers, #20G
269 St. Joseph's Way	614 Spruce Street		



JOANNE DAVIDOW

MIDTOWN REALTY CORP.
210 W. Rittenhouse Square, #406
546-0550



LOLLY LAGRECA

Make Yourself Heard: Riverboat Gambling

A coalition of 10 neighborhood groups has formed "...to investigate and analyze the impact of expanded gambling on Philadelphia businesses and neighborhoods — with the goal of developing a plan of action that addresses the concerns of participating groups." These 10 organizations represent about 50,000 Philadelphia residents and business owners of all social and economic means.

The geographic boundaries of the coalition stretch from Lehigh Avenue, on the north, to Snyder Avenue, on the south, and extends into the heart of Center City. It includes the city's oldest and most historic neighborhoods, such as Queen Village, Washington Square, Old City and, of course, Society Hill.

Lawrence Meehan, who represents SHCA, has asked that members of our community fill out the following survey, which is also being distributed among all the other associations. The survey will be tabulated, and we will share the results among all member groups.

Please fill out the survey and bring it with you to our next meeting— on May 21 at Pennsylvania Hospital. If you cannot attend, fill out the questionnaire anyway, and send it directly to: Lawrence Meehan, Hopkinson House, Apt. # 2603, 604 S. Washington Square, Phila., PA 19106. (Or, you can also send it to the SHCA office and they'll forward it: SHCA, P. O. Box 3, Phila., PA 19105)

Riverboat Gambling Survey

- | | Yes | No |
|---|--------------------------|--------------------------|
| 1. Would you support a proposal of riverboat gambling in the city of Philadelphia? | <input type="checkbox"/> | <input type="checkbox"/> |
| 2. Would you support a proposal of video poker in any establishment with a liquor license in Philadelphia? | <input type="checkbox"/> | <input type="checkbox"/> |
| 3. Would you support a proposal of slot machines in Pennsylvania racetracks? | <input type="checkbox"/> | <input type="checkbox"/> |
| 4. Would you support any gambling expansion if revenues from gambling were earmarked for schools, community development or other social programs? | <input type="checkbox"/> | <input type="checkbox"/> |
| 5. Rank the importance to you of proposed benefits of expanded gambling (riverboat gambling and video poker) in Philadelphia: | | |

	Less or more important				
	1	2	3	4	5
Increase revenue for city	1	2	3	4	5
Decrease wage tax	1	2	3	4	5
Jobs in construction	1	2	3	4	5
Jobs in casinos	1	2	3	4	5
Development of river-front	1	2	3	4	5
Increase tourism	1	2	3	4	5
I would frequent casinos	1	2	3	4	5
Other _____	1	2	3	4	5
_____	1	2	3	4	5

6. Rank each area of concern with which neighborhoods should have discussion and input with city and state officials

	Less or more important				
	1	2	3	4	5
Crime	1	2	3	4	5
Traffic	1	2	3	4	5
Parking	1	2	3	4	5
Quality of life issues for residents	1	2	3	4	5
Pollution	1	2	3	4	5
Negative impact for established businesses (stores, cafes, movies)	1	2	3	4	5
Compulsive gambling	1	2	3	4	5
Hours of operation	1	2	3	4	5
Location & size of casinos	1	2	3	4	5
Other _____	1	2	3	4	5
_____	1	2	3	4	5

7. My neighborhood is Society Hill

8. Comments:

Society Hill and Washington Square's Premier Condominiums

NOW AVAILABLE FOR SALE

Society Hill Towers

200-220 Locust Street

One bedroom, northwest corner, city view, 750 sq. ft.....\$79,900

One bedroom, one bath, northeast corner, bridge and river views, 775 sq. ft.....\$90,000

Two bedroom, two bath, corner with city view.....\$132,500

Two bedroom, two bath, corner with river view.....\$155,000

Three bedroom combination (Two bedroom & adjacent one bedroom) with panoramic bridge & river views.....\$295,000

Hopkinson House

604-36 S. Washington Square

Studio, high floor, park view, 600 sq. ft.....\$59,900

One bedroom delux, south view, high floor, W/D.....\$82,500

One bedroom delux, southern exposure, 1003 sq. ft.....\$85,000

Two bedrooms, two baths, balcony, southern exposure.....\$119,900

Three bedroom + one bedroom combination to form a 3 bedroom with den, customized interior, large terrace, large customized master bath.....\$275,000

Independence Place

233-241 S. 6th Street

One bedroom, south view, 789 sq. ft.....\$74,900

One bedroom, Locust walkway, available ASAP!.....\$77,500

Two bedroom, two baths, park view, corner, upgraded.....\$240,000

Three bedroom, high floor, panoramic southern exposure & River view, beautiful home\$399,900

Three bedrooms, high floor with southeast River views.....\$419,900

Three bedroom with den, formal dining room, 2594 sq. ft.....\$425,000



Allan Domb Real Estate

Philadelphia's Largest Luxury Condominium REALTOR®

215-545-1500

1608 Walnut Street, Suite 1303, Philadelphia, PA 19103

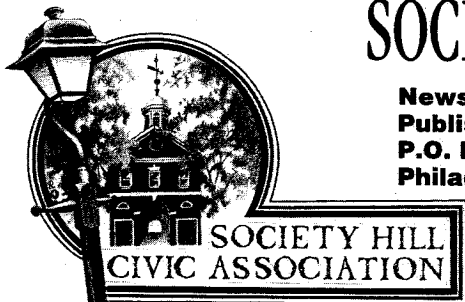

SOCIETY HILL REPORTER

**Newsletter for the Residents of Society Hill
Published by the Society Hill Civic Association
P.O. Box 3
Philadelphia, PA 19105**