



Society Hill REPORTER

...Working Together
For a Better Place To Live

Summer 1998

Newsletter of The Society Hill Civic Association

No Money, No Cleaning

Sidewalk Sweeping Ends September 1

On Wednesday, July 17, the SHCA Board of Directors decided to discontinue the sidewalk sweeping program until the remaining \$4,800 to fund it can be raised. David Stevens, who spearheaded the effort to get the program started, told new board members that even he felt it should be discontinued — at least temporarily — unless enough residents come forward to pay for it. The original plan to finance the program each year was calculated on taking \$10 from all 1996 current members' dues and enrolling new members at \$40 for the total needed of \$14,400.

Matt DeJulio, chair of the Membership Committee, reports that paid household and corporate memberships stand at 686. While membership has never been higher (triple growth from 1990), it falls 124 members short of what is needed to fund sidewalk sweeping for a calendar year. When membership fell short last year, individuals in the community sent contributions, which the Society Hill Fund matched; a gov-

ernment grant through Senator Vincent Fumo's efforts was obtained; and the Board earmarked funds from the treasury to fill the gap. The prevailing feeling this year was best expressed by David, "Some people need the shock of seeing how bad it can get to realize they have to contribute, too."

The SHCA had paid on a month-to-month basis the Center City District's contractor to clean the sidewalks each Tuesday morning. Tuesday was chosen as the weekly time because it follows Monday night trash pick-up, which ironically causes more litter.

To re-start the program, please send in \$40 for 1998 dues to SHCA at Box 3, Philadelphia, PA 19105 or send a contribution of any amount to The Society Hill Fund, Project Street Sweeps, c/o David Stevens, 116 Delancey Street, Philadelphia, PA 19106. Spruce Street neighbor Howard Sedran of Levin, Fishbein, Sedran & Berman has started the effort with a \$250 corporate membership.

Where Does That \$40 Go?

The SHCA Board of Directors felt it timely to share with all the members and the community at large exactly where the money comes from to support this organization and how the money is spent. Sweeping the 70 blocks of sidewalk once a week and publishing this newsletter six times a year to keep the community informed consume the lion's share of the annual budget.

The newsletter is distributed to all of the 2,600 plus households in the community. Project Street Trees has subsidized up to \$100 each for the replacement of 109 diseased or dead trees. SHCA belongs or contributes to several organizations in the neighborhood and city that benefit the quality of life in this community, i.e. The Philadelphia Society for the Preservation of Landmarks, etc.

Occasionally, one time donations are made to special causes, i.e. a

\$500 contribution to the legal fund for the Preservation Alliance for a Greater Philadelphia in their efforts to establish the legal teeth of "Designated Historic Neighborhood" or for legal fees in fighting zoning matters. The Board wants to provide quality programs for the General Membership meetings and to provide social functions where neighbors can get a chance to know each other. Painting lamp poles, equipping the Tree Tenders, running two Clean Up Days each year also cost money. Everyone, with the exception of a part-time, paid administrator, volunteers his/her time and talents.

Treasurer Perry Whyte prepared the following two charts. But the bottom line is — We need more people in the community to sign up for membership in order to continue our programs and initiatives.

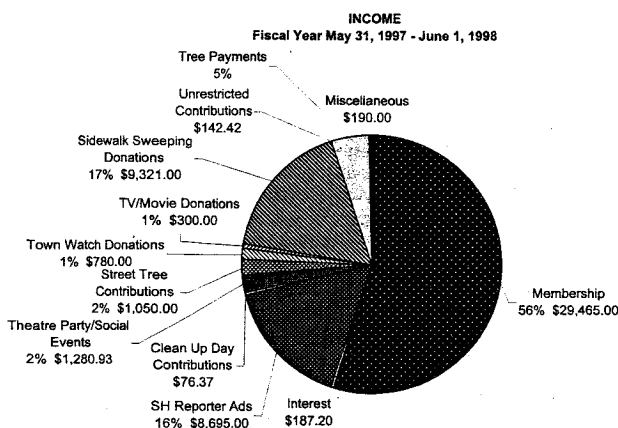

Synopsis	
Income	\$53,922.92
Expenses	\$62,567.81
Cash Flow	(\$ 8,644.89)
Savings	\$11,550.26
Checking	\$ 2,116.24

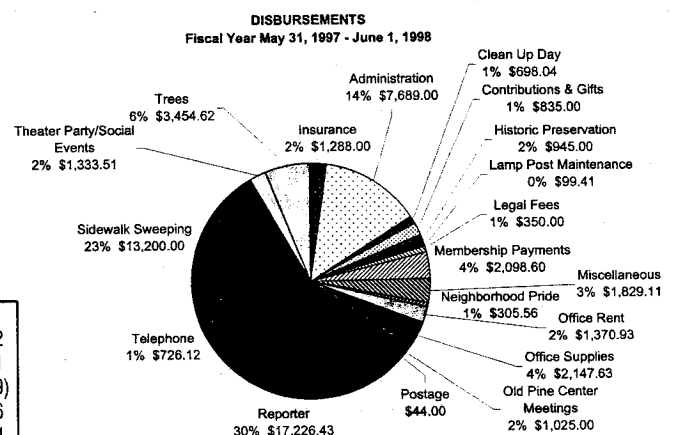

Unbent Dart

Bill Gursik took umbrage with the Jeeves Dart about trash from the McCall School. Seems Bill is the building superintendent of the school for the last dozen years and takes great pride in keeping the place nice for the students. He told us a dumpster inside the schoolyard for on-grounds trash pick up should solve the problem. He also ratted on neighbors who have been dumping their household trash in with the privately hauled school trash. Dumpers — consider yourselves BUSTED!

SHCA's sincerest "thanks" to the merchants who contributed goods and services for the Welcome Baskets for new Society Hill homeowners:



Baker Street Old City Coffee SuperFresh
 Chef's Market Riff's Cleaners Zeke's Deli

4 AAAA Building & Design Consultants

(215) 829-1633

Interior-Exterior Design

Specializing in Structural Problems

- Cracks • Unlevel Floors
- Sinking • Leaks

Feasibility of Improvements

- Roof Decks • Additions
- Excavation • Multi-Family

AVIS

AVIS RENT A CAR SYSTEM, INC.

Rosemarie Weinberg
 (215) 629-1333
 (215) 928-1082
 FAX (215) 627-0385

Office Location
 37 S. 2nd Street
 (Between Market &
 Chestnut Sts.)
 Philadelphia, PA
 19106

Monday-Saturday 8am- 7pm • Sunday 9am - 4pm

jazzercise®

Get fit with the world's #1 fitness program

Evening classes - Society Hill

Morning classes - South Philadelphia
(on site child care available)

- No long term contracts/enrollment fee
- Reimbursable by many health plans
- Class pass good at both locations

2 1 5 - 6 2 5 - 9 1 2 5

INSURANCE CHECKLIST



Scott Mutchnick
 215-432-8965
 mutchnick@erols.com

- ✓ Health Insurance - *Group & Individual Plans*
- ✓ Disability Income - *Protect Your Most Valuable Asset — Your Ability To Earn An Income*
- ✓ Business Insurance - *Many Companies Available*
- ✓ Life Insurance - *5-10-15-20 & 30 Year Level Premiums*
- ✓ Medicare Supplement - *Monthly Rates As Low As \$59.89. Same Coverage As AARP*
- ✓ Dental - *Visit Any Dentist You Wish*
- ✓ Long Term Care - *Home Health Care & Nursing Home Protection*

**CALL TODAY TO RECEIVE A FREE
 COST AND BENEFIT COMPARISON!**

Representing Over 25 Insurance Companies

Society Hill REPORTER

published by
 The Society Hill Civic Association
 P.O. Box 3, Philadelphia, PA 19105
 Phone (215) 629-1288 • Fax (215) 592-4239

EDITOR

Mary Sturdivant

EDITORIAL BOARD

Matthew DeJulio • Joel Eichen • Amy Foran
 Bernice T. Hamel • William Hawkins • David Woods

CONTRIBUTORS

Richard Bost • Barbara Gelman • Bill Hawkins
 Martha Levine • Larry Meehan • Liza Seltzer
 Norman Tissian • Perry Whyte

BUSINESS AND ADVERTISING

William Hawkins

GRAPHIC DESIGN

Norman Kline

CONTRIBUTIONS WELCOMED

Next Editorial Deadline: September 15, 1998
 Mail or fax contributions to above address.

Chairs Chat

Zoning

Will Smith, native West Philadelphian and a.k.a. *The Fresh Prince of Bel Air*, has deposited money for the defunct NewMarket site to develop a low-rise hotel.

The unlicensed custom bridal gown design business from the 500 block of Spruce has relocated to South Street, at least temporarily.

According to Chair **Richard Bost**, no immediate neighbors objected to the new owner's proposed zoning variance request to enclose the penthouse deck in the 300 block of Delancey Street (former residence of Nancy Glass).

Richard also reports he gets occasional irate phone calls about aesthetic issues, such as air conditioning units in first floor windows. No zoning ordinances address this matter. Historic Preservation chair **Bernice Hamel** notes that historic designation status would give SHCA the legal position to address such issues.

The rather large, blue neon sign outside the new Italian restaurant at Society Hill Towers prompted letters to be sent to Licenses & Inspections requesting that in the future they follow regulations and submit sign applications for the approval of the Art Commission. Its position on the north side of the building does not affect any residents.

No one seems pleased either with the very prominent banners at the derelict former Society Hill health club on 5th Street. They are temporary; but immediate residents are even more alarmed at plans to convert the tennis courts to a basketball court. Compare the difference in game etiquette — one favoring court chatter and the other clearly considering shouting as bad form. A private meeting with the operator is scheduled.

While SHCA continues to oppose chain store and fast-food takeouts on South Street, the Board did **not** approve a \$900 request to continue to fight the Burger King/Taco Bell move into the Aaron Mattress site.

Finally, Pennsylvania Hospital is proceeding with the renovation of the orthopedic center in the former Farm Journal building on Washington Square. Some suggestions by immediate neighbors have been incorporated into the design; others proved too costly; and rerouting traffic on Manning Street proved highly unpopular with Washington Square residents.

Liquor Control

Mel Buckman will chair this committee. **Michael Harwood** of Dickens Inn has re-applied for a liquor license to operate an outdoor café at the HeadHouse shambles, but not closing 2nd Street this time. The operator of the Cabaret at NewMarket has applied for a zoning change to expand the uses of the premises, but his tenancy will be vacated if the property is sold.

Neighborhood Pride

Martha Levine reports her committee has leafletted all the homes in the community asking owners to turn on their outside lanterns or leave lamps or electric candles lit in ground floor windows. Also, she will work with Joe Doyle at the Streets Department to install a block of 70-watt, high pressure sodium lighted Franklin Lamps to test the aesthetic appeal and safety improvement.

Welcoming baskets have been delivered to new home owners, a program initiated by Martha. Merchants who contributed are listed on page 2.

Town Watch

Barbara Gelman is setting up a series of meetings so residents can report safety concerns and get them addressed in a timely manner by the Sixth Police District. The first will deal with car break-ins. Even if you don't own a car and are just tired of sweeping up broken glass, you can attend. See you at 8 pm on Thursday, July 30, at Old Pine Community Center, 4th & Lombard.

National Night Out, Tuesday, August 4th, will be marked with two events: a rally at City Hall from 12:00 to 2:00 PM with music and entertainment and a walk starting at 8:00 PM from the HeadHouse Shambles.

Exciting News! The Center City District is planning to establish a **Municipal Community Court** to deal with misdemeanors — the minor, quality of life crimes that can have such a negative impact on the joys of living in a city. A major grant from The Pew Charitable Trusts has funded the requirements study. SHCA hopes to have the plans unveiled at the October General Membership meeting.

Historic Preservation

Bernice Hamel assures us every home owner will in early fall receive a letter from the Philadelphia Historic Commission informing them of the public hearings to attain historic designation. This is an important and sometimes controversial initiative for any neighborhood.

Rittenhouse/Fitler Square is the only historic designated neighborhood in Philadelphia at present. A handbook written for them by the Preservation Alliance for Greater Philadelphia, *A Guide for Property Owners*, is available after August 1 for \$10 each. Call the Alliance at 546-1146 for a copy.

Bernice proudly announces the installation of new signs informing people about Society Hill and the Head House and market at the Shambles. Researched and written by herself and **Penny Batcheler**, retired historical architect for Independence National Historic Park, the Society Hill sign's design was paid for by SHCA and all other costs were picked up by the HeadHouse Conservancy. The total of three signs (another for Queen Village) fit visually well with all the new signs installed at community houses of worship, a project of the Old Philadelphia Congregations.

Patricia Wilson Aden, senior vice president of the Alliance, hosted the first in a series of lunchtime meetings at St. Peter's Episcopal Church house, for the Historic Neighborhood Network. **Cathy Apothaker**, **Stanhope Browne**, **Matt DeJulio** and **Bernice** represented Society Hill for this group whose mission is to identify concerns and articulate issues unique to historic neighborhoods.

Library

Liza Seltzer reports that the Balch Institute has approached the committee with an offer for space. The other viable site they are considering is the former restaurant location in the Penn Mutual Tower building on Walnut Street.

Carriage Horse Trade

Bill Hawkins disappointedly informs us that Bill 980239 to enhance waste management, change routes, eliminate peak rush hour operation, and improve the working conditions for the horses was contested by the

Continued on page 5

This weeks featured property..

FOR SALE

FOX & ROACH
REALTORS

www.foxroach.com
215-546-0550

Formerly **midtown**
realty corp.

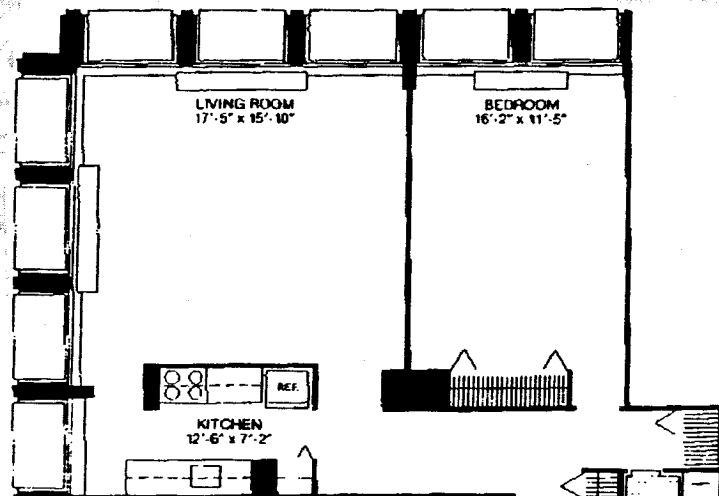

Society Hill Towers Magnificent corner One Bedroom. Spectacular river views. High floor. Wd flrs. Pool & Parking available. \$135,000.

SOCIETY HILL CONDOS AND TOWNHOMES FEATURING...

- 114-16 Pine Society Hill Gorgeous dbl propert... lovely gardens & pool, hw flrs, hi ceil. LR overlks gdn, FDR, 4 BR... rary, 2 Powder Rms. **\$795,000.**
- 239 S. 3rd I.M. Pei designed 3+BR town... **PARKING!** **\$429,000.**
- 214 Spruce Period House, PARKING... k, 3.5b, 8 fireplaces! **\$419,000.**
- Society Hill Towers 2000 sq ft... net kit **\$395,000.**
- Independence Place Corner... DR, eat in Kitchen, Library. **\$390,000.**
- 322 S. 2nd Delancey Me... use, 2.5b, fp, gdn & PARKING **\$285,000.**
- 410 Lombard Excepti... y facade, 4BR, central air, PKG **\$169,000.**
- 419 S. Perth Charm... all Park. Large gdn, 2 fps, wd flrs **\$115,000.**
- Society Hill Towers... k, city and sunset views **\$99,000.**
- Hopkinson House Lg... w/alcove. Overlooks Square! Parquet flrs. **\$65,000.**
- Abbotts Square Lovely 1BR on 5th fir facing North. Great condition **\$65,000.**

BRAND-NEW SOCIETY HILL LISTINGS!!!

- 234 Delancey Historic 4BR, 3.5b features fps, formal LR, sep DR, orig details & gdn **\$459,000.**
- 213 Delancey Traditional 3BR, 2.5 b. Pristine! Sep DR, fpl, gdn, deeded PARKING **\$389,000.**

MLS Market Ready Condos & Townhouses MLS

JOANNE DAVIDOW, VICE PRESIDENT

Barbara Auritt • Phillip Carman • Elizabeth Caulk • Wendy Chercass • Patty Hogan • Linda Holt • Rose Ann Jugla • Lolly LaGrecca • Bill Lederer
Doris Levine • Janet Margolies • Laurie Phillips • Olenka Santore • Ellen Steiner • Ilene Wolgin

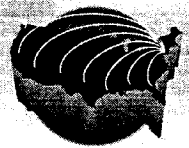

RELOCATION SERVICES DIVISION
Our 35-member, professional team generates over \$500 million in sales annually. When you need to relocate, we stand ready and able to sell your home and find you a new one quickly and easily.

At The Rittenhouse
210 W. Rittenhouse Square, Suite 406
Philadelphia, PA 19103 (215) 546-0550

An Exclusive Affiliate
SOTHEBY'S
International Realty

Chairs Chat, *continued*

owners of the carriage companies and their counsels. The bill never made it out of committee despite strong support from residents and equine experts from around the region. Bill urges concerned people to write, call or fax Councilman Frank DeCicco at Room 332, City Hall, Philadelphia, PA 19197, 686-3458 or 3459, Fax 686-1931.

CPNA (Coalition of Philadelphia Neighborhood Associations)

Larry Meehan reports that a bill introduced by State Representative Terry Van Horne (Democrat from Allegheny) to permit counties to open keno parlors found little support. For now, riverboat gambling appears as a dead issue in the legislature. CPNA (which includes SHCA, the Society Hill Towers Owners Association, South Street Neighbors Association, Queen Village Neighborhood Association, Old City Civic Association, Fishtown Civic Association, Friends of Pennsport, Center City Residents Association, Residents of Greater Manayunk, Northern Liberties Neighbors Association and the 21st Ward Community Council) is exploring its mission and has met with Councilman-at-Large, David Cohen, to discuss strategies about the sponsorship of Council resolutions that might lead to public hearings. Dick Ostrander, the other liaison to CPNA, is firmly opposed to the group's enlarging their mission from lobbying against gambling in the state.

Homeless Intervention

Joan Less will continue to act as the contact point for anyone in the community who has a concern about someone who appears to be homeless in the neighborhood. The committee has been disbanded because they felt the services were adequate in the area and any other real intervention would require more time than anyone could commit.

Yo! Lighten Up!



A big thank you to all homeowners who by turning on their exterior front lanterns every night are keeping Society Hill brighter and safer. Keep those lights

burning from dusk to dawn to deter crime on the streets. The cost to burn a 40 to 75 Watt bulb is only 13¢ a day.

Away a lot, get home really late, or does it just keep slipping from your busy mind? Home

PIANO LESSONS WITH BETSY ALEXANDER

- ♫ RECOGNIZED TEACHER & COMPOSER WITH MUSIC CONSERVATORY DEGREE
- ♫ PROVEN MOTIVATOR OF STUDENTS OF ALL AGES
- ♫ VARIED METHODS TO BEST SUIT EACH STUDENT
- ♫ BEAUTIFUL SOCIETY HILL PIANO STUDIO
- ♫ UNUSUAL OPPORTUNITY TO LEARN FROM A WORKING COMPOSER
- ♫ FRIENDLY PARAKEET, GREAT STICKERS, FUN LEARNING ENVIRONMENT

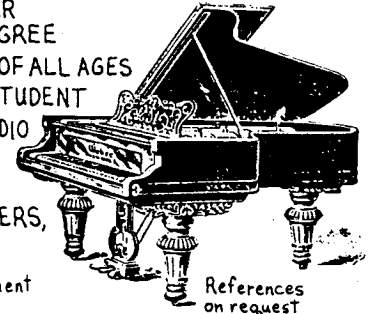

For a free evaluation & interview appointment call **627-7664**

References on request

“If you like saving money on car insurance, give me a honk.”

Before the cost of insuring your car leaves you a total wreck, give me a beep, a honk, or even a simple phone call. I'll work hard to come up with a quote that's just what you're driving at.

Allstate
You're in good hands.

Jamie Matika, Exclusive Agent
Allstate Insurance Company

126 Lombard Street, Philadelphia, PA 19147
Bus (215) 413-5800 • FAX (215) 413-7038

We've gone condo.

Because you've gone condo. And your condo is your home. Like our homeowners insurance, our condo insurance is outstanding. From fire and smoke damage to theft, you're protected. Call today for the full story.

Depot on Delaware Avenue carries a light sensing socket which automatically turns the bulb on at twilight, off after dawn. Screw it into your lantern and forget about it! Also, autotimers can be installed at the switch by an electrician

or Bob Villa wannabe. Motion detectors in back alleys that turn on flood lights really deter intruders and help homeowners safely down their own paths! Questions or for electrician referrals, please call Martha Levine at 629-0727.

•NEW OWNERS •NEW SERVICES •NEW APPROACH

Society Hill Realty Company, Inc.

206 South 3rd Street • Philadelphia, PA 19106

215.925.9403 • Fax 215.925.9661

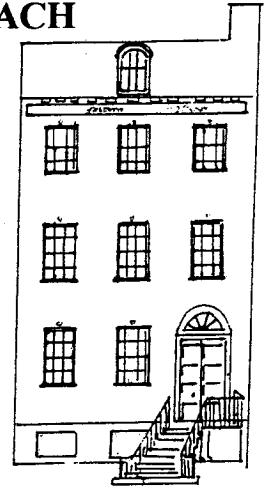

THE PERSONAL SERVICE PROFESSIONALS
WHO OFFER YOU:

FULL SERVICE BROKERAGE
BUYER AGENCY
PROPERTY MANAGEMENT

PROPERTY MAINTENANCE-WHOLE HOUSE/ RENTAL UNITS
(By:Facilities Management Services)

TENANT SERVICES AVAILABLE LANDLORD SERVICES

THE COLDSPRING GROUP

COLDSPRING DESIGN ASSOCIATES
Housewright Partners, Inc.

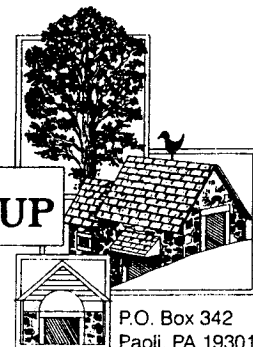

P.O. Box 342
Paoli, PA 19301

DESIGNER/ BUILDER

•HISTORIC RESTORATION • REPRODUCTION
•SUNROOMS & CONSERVATORIES
•ADDITIONS & RENOVATIONS

•PROPERTY MAINTENANCE-WHOLE HOUSE/ RENTAL UNITS
(By:Facilities Management Services)

(610)-296-3506 Fax: (610)-889-0489

City Kids

 The Philadelphia Orchestra offers two wonderful ways to introduce children to classical music: Preschoolers (ages 3-5) will love the *Sound All Around* series in which Storyteller Blake Alston and members of The Philadelphia Orchestra present an informal and fun-filled exploration of music.

The 35-minute concerts are held in 5-concert series at 10:00 a.m and 11:15 a.m on the following Mondays: 10/26, 12/7, 2/15, 3/15, 4/30 (this one's a Friday). The Saturday series is performed at 10:00 a.m and 11:15 a.m on 10/24, 1/9, 2/20, 3/13, and 4/24. Cost for the series: \$25.

Children ages 6 to 12 will have the chance to experience great music in performance that feature dancers, storytellers, young virtuoso soloists and world-class conductors in the Family Concert series, held on the following Saturdays at 11:30 a.m.:

- 9/19 The Story of Babar
- 11/14 Gotta Dance
- 1/23 It's About Time
- 3/20 Composer's View
- 4/10 A Family for Baby Grand

Ticket prices for the Family Concert Series begin at \$18.

Call 893-1955 for details on either series.

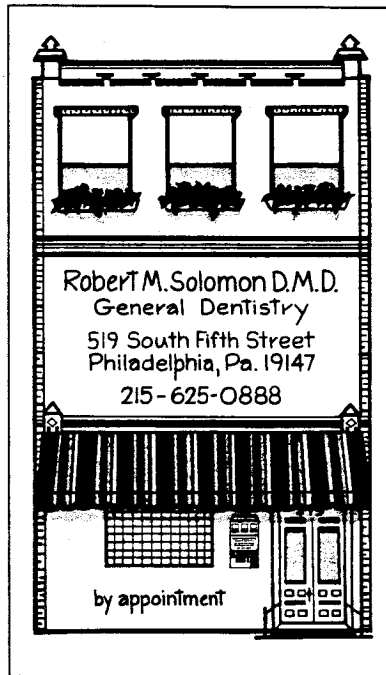

Robert M. Solomon D.M.D.
 General Dentistry
 519 South Fifth Street
 Philadelphia, Pa. 19147
 215-625-0888
 by appointment

DON'T BE MISLED OR MISFED.

There's only one world famous steak & seafood restaurant in Philadelphia. Only one restaurant where your hosts, the Taxin family, will make you feel like a big fish. For a lunch or dinner that will go down in history, don't miss visiting Philadelphia's only landmark restaurant in old city, not center city.

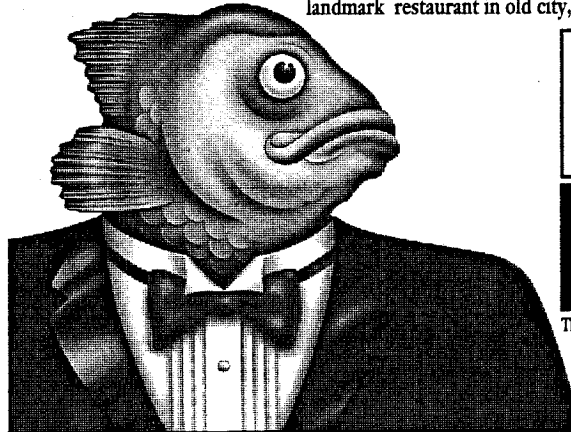

10% OFF
 Food portion of check when you present this ad

THE OLD ORIGINAL
BOOKBINDER'S
 The World Famous Restaurant Down By The River

2ND & WALNUT STREETS • 925.7027 • VALET PARKING (FREE AT LUNCH) • MAJOR CREDIT CARDS ACCEPTED

One Body - That's All You Get.

Lose Weight
 Prevent Bone Loss
 Improve Cardiovascular Fitness
 Increase Strength and Flexibility

... and Do It In Your Own Home

RICHARD GIBSON

Certified Strength & Fitness Trainer - References Available

215-923-6435

Specializing in Fitness for Older Adults

Construction is in full swing on the 6th Street side of Washington Square, and this section should be completed by the end of 1998.

Laurels to Jerry Balter, Anne and Chris Clark, Craig Eisendrath, Theresa Fera, Bill Hawkins, Herb Lipton, Nicholas Moore, and Roger Moss for getting part of the Square opened throughout the renovation.

Completion for Phase I: July 2000. Oh, what a party we will have!



Photo - Bill Hawkins

Pileggi

ON THE SQUARE



TOTAL CARE
HAIR
BODY
FASHION
ACCESSORIES
AND
SHOES

715-717 WALNUT ST, PHILADELPHIA

SALON 627-0565
BOUTIQUE 922-3526
SHOES 829-9292

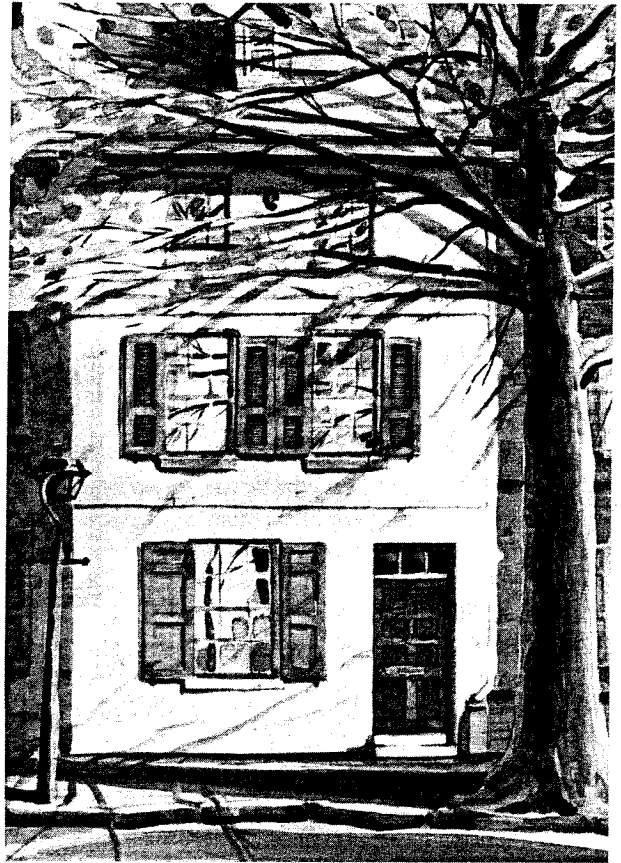

"The Commodore Bary House", Society Hill, watercolor 1998

A PORTRAIT OF YOUR HISTORIC HOME

by Award Winning Watercolorist

PAMELA SINKLER-TODD

*Enjoy a beautiful, personalized work-of-art that
will become a cherished heirloom for generations.*

*Call and discuss with Pamela how she can
turn your home into a masterpiece.*

A color brochure is available on request.

Phone 215-925-0646

Fax 215-925-1762

www.mindspring.com/~pamelatodd

Philly Deli

- delicatessen
- restaurant
- informal catering
- box lunches

410 412 SOUTH ST. PHILA. PA 19147-1535
215-923-1986 FAX 215-923-2299

SHANNON

FITZPATRICK
APPRAISER - GEMOLOGIST - GIA

- INSURANCE REPLACEMENT APPRAISALS 716 SANSOM STREET
- ESTATE APPRAISALS SUITE 1
- GEM AND METAL IDENTIFICATION PHILADELPHIA, PA 19106
- DIAMOND AND ESTATE BROKERAGE 215-922-0607

Things To Do At The Down Town Club

- ✓ Have A Romantic Wedding Reception
- ✓ Hold An Important Business Meeting
- ✓ Celebrate Your Birthday In Style
- ✓ Herald A Festive Holiday Party
- ✓ Enjoy The Best View In The City
- ✓ Toast Your 25th Anniversary
- ✓ Shop For Wedding & Corporate Gifts

At "Endearments" Gift Boutique
(by appointment only)

Think of The Down Town Club
Catering & Conference Center For Your Next
Special Occasion or Corporate Event.

Call For A Personal Tour Today!
(215) 925-2040

<http://www.downtownclub.com>

S.W. Corner of 6th & Chestnut Streets, Philadelphia, PA 19106

Trust
your neighbors
for your important
insurance needs

Mather & Co., Insurance Brokers

—here in Society Hill for
over a century



Call us for answers about insurance
for your business, life, group health and
accident, boat, fine arts and jewelry,
and expensive home.



MATHER & CO.

226 Walnut St., Philadelphia, PA 19106
(215) 925-0118

*Trust our experience
as insurance brokers since 1873*



Photo - Bernice Hamel

Former SHCA president Mel Buckman accepts an 1860 City Plan chosen by Jay Pattison of the Washington Square Gallery on Chestnut Street. More than sixty neighbors came out on a very muggy June 24 evening to meet new board members, Norman Tissian, president, Janet Cooke, Howard Lander and Mary Sturdivant, vice presidents, Perry Whyte, treasurer, Mark Keener, recording secretary, and new quadrant directors Rhoda Haber, Jacqueline Hokanson, Bill Hawkins, Joel Eichen, and Martha Levine. They join incumbent directors William Sells, Jane Stevenson, Matt DeJulio, Richard Bost, Liza Seltzer, Barbara Gelman, Deborah Robinson, George Compton, Joy Lindy, and Bruce Thompson.

Save The Date!
 Next General Membership Meeting:
 Wednesday, October 21, 1998, 7:30

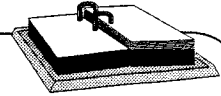

**R. CHOBERT
 PAINTING &
 PAPERHANGING**

833 S 2ND ST PHILA

MAY WE
 BRING SOME
 COLOR
 INTO
 YOUR LIFE ?



(215) 389-7788

CREATING BEAUTY SINCE 1967

Visit the *M*useum Shop

For gifts and ceremonial
 objects for all holidays
 and celebrations

*The Museum Shop of the
 National Museum of
 American Jewish History*



55 North Fifth Street
 Independence Mall East
 215.923.0262

Your neighborhood store for Judaica



**Your Realtor® For
 Buying A Home
 & Selling A Home**

Bari Shor

"Real Estate MatchMaker"

- Bari works harder.
- Works smarter.
- Cares and *delivers* on your Center City Home Ownership dreams.

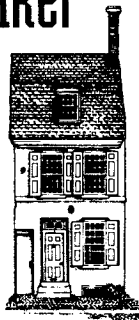

**Call me, Bari Shor, 215-587-6912
 Fox & Roach Realtors®**

1800 JFK Blvd, 14th Floor Philadelphia, PA 19103 215-561-1500

Appraisals

Complete Fine Arts and Household
 Appraisal Service for Insurance,
 Estate Liquidation, Sales and Gifts.
 Flat Rates.

For Information Please Call 242-0375

CHANDLEE & BEWICK

7811 Germantown Ave., Chestnut Hill
 Philadelphia 19118

WM. H. CHANDLEE III

*Member of The Appraisers Association
 of America*



The Award Winning Team of

MIKE McCANN

"The Real Estate Man"

The Ultimate in
Real Estate Service

★★★★★

EXCLUSIVE LISTINGS:

Call for an appointment to see:

630 Pine St- 4 unit apartment bldg with 4 car parking! All sep mtrs. Good condition! \$369,900

2nd & Delancey- 3 bdrm, 2.5 baths, parking, garden, deck, f/p, hardwood floors, c/a \$329,900

506-08 S. 8th- Contemporary 4 bdrm, 2.5 bath, den, 2 car garage, garden, c/a! \$349,900

530 S. 2nd St- Beautiful bi-level 3 bdrm corner penthouse condo, 2 baths, 3 patios \$199,900

812 Lombard- Lovely courtyard home. 3 bdrm, 3 baths, deck, 2 f/p, c/a, parking available \$154,000

905 Lombard- Spacious 3 bdrm, 1 bath, yard, pine floors, f/p, c/a, deck, great space! \$139,000

7th & Addison- Charming 2 bdrm, 1 bath home with hardwood floors \$115,000

1227 Panama- Charming 2 bdrm, 1.5 bath home, 2 f/p, tree-lined cobblestone street! \$95,900

★★★★★

JUST SOLD!

240 S. 3rd St \$830,000 702 Pine \$795,000

203 Delancey \$349,500 503 Pine \$475,000

126 Delancey \$325,000 439 Pine \$355,000

514 Cypress \$136,000 919 Spruce \$271,450

1134 R1 Waverly \$105,000 417 S Perth \$117,000

★★★★★

CALL MIKE McCANN

and his 5 Star Team!

PRUDENTIAL PREFERRED

414 Walnut Street, Phila, PA 19106

215-627-6005★215-440-8345

www.mccannteam.com



Society Hill Towers Plaza
257 Saint James Place
Philadelphia, PA 19106

API Member
The Nation's Premier Travel Consultants™

215-923-4300 • 800-523-1650
Monday - Friday 9-6 • Saturday 11-3 pm



Quality Travel Services
for
31 years

Plumer & Associates, Inc., Realtors

Largest Independent Realtor in Center City

- 30 experienced agents
- Member multiple listing
- Relo-relocation network
- Property management

Residential • Commercial • Investment

**Local brokers who have an
interest in the neighborhood
75 years of support to the community.**

Your business is important to us!

Give us a call!

realtors **plumer**® **922-4200**
associates, inc. **226 South St.**

Message from the President



Hello to all my neighbors!

I'm **Norman Tissian**, and I have agreed enthusiastically to serve as the President of the Society Hill Civic Association (SHCA).

I have lived in Society Hill for over thirty-years, the first five as a renter in the Society Hill Towers and the last twenty-five as a homeowner. I have always been a member of SHCA, an organization that despite many problems, I have believed in from the start. I have agreed to become president in the hope that there are many residents of this community who hold similar beliefs to my own regarding the future of Society Hill.

I believe that Society Hill is a residential community, but thoroughly unique in its location at the heart-of a major city. I believe that our residences, be they house or condo, are first and foremost *homes* and only secondly *real estate investments*. I believe we all chose to live here, in the heart of the City, and thus recognize that Society Hill is not a Gladwyne or Huntingdon Valley.

Yes, as in all great cities, from Paris to San Francisco to Tokyo, we have noise, and dirt, and street crime and crowds of people on our streets that we can probably do without. But we also have all of the benefits — the culture, the diversity, the conveniences of living in the heart of our wonderful and important city.

Many changes are underway in downtown Philadelphia. This city's only significant prospect for major economic growth in the near future is in tourism and conventions. This means more hotels, more retail complexes, more restaurants, more night life. Like it or not, these changes are

inevitable. We cannot stop them, nor do I think we should.

Which is not to say, however, that we should meekly yield to these changes. We have a great responsibility to monitor carefully these "developments." In fact, I believe that a positive and active community can actually play a major role in directing these changes, both for the good of our neighborhood and the city at large. We can be positive leaders rather than negative followers of the *status quo*.

We cannot pretend that our community is as it was just ten years ago. We cannot oppose all change. We cannot afford to be a divided community, one that loses all civility with screaming and cursing at one another as has taken place at some SHCA meetings.

SHCA now plays a major role in keeping our community safe, clean and thriving. SHCA pays for sidewalk cleaning, tree planting, Town Watch, this newsletter, street lamp pole painting, and much more. We lead the fight for our interests in zoning and liquor license issues. We are the leaders in bringing a library to our neighborhood. We do all this, despite the fact that less than a third of households pay the nominal annual membership to SHCA. Even fewer attend our regular General Membership meetings.

We need new members! We need members who are positive and creative and are willing to get involved in the life of our neighborhood. Residents with young families are especially encouraged to join. Why not a Charter School in our neighborhood? We seek members who will help guide SHCA.

We need the energy, the creativity, and enthusiasm that I know exists in our residents. I, and your Board of Directors, welcome your thoughts, concerns, and ideas.

**Society Hill and Washington Square's Premier Condominiums
NOW AVAILABLE FOR SALE**

Society Hill Towers
200-220 Locust Street

Studio, high floor, bridge & river views, 528 sq.ft.....\$69,900

Corner one bedroom, town- house view, S/E corner.....\$94,900

Two 2 bedrooms combined with a one bedroom to form a large three bedroom with study, eat-in-kitchen panoramic views to the North, East and South, 2,656 sq.ft, customized kitchen and bath.....\$485,000

Hopkinson House
604-36 S. Washington Square

One bedroom, balcony, South view, 778 sq. ft. **SOLD**.....\$82,500

One bedroom, high floor, balcony, park view.....\$92,500

New! **SOLD** Deluxe one bedroom, park view, 1,061 sq. ft.\$97,500

Two bedrooms, 1 1/2 bath, terrace southeast view.....\$119,900

Independence Place
233-241 S. 6th Street

One bedroom with alcove, 1 1/2 baths, high floor, city view, in excellent condition.....\$159,900

Two bedroom, 2 bath, lower floor, sunny southwest exposure, balcony, eat-in-kitchen, 1387 sq.ft.....\$164,900

Three bedroom, panoramic view southeast corner, high floor, in excellent condition.....\$469,900

Abbotts Square
530 S 2nd Street

One bedroom, 1 1/2 baths, excellent value.....\$84,900

Deluxe corner one bedroom, 1 1/2 baths, balcony.....\$104,900

Pier 5

7 N. Columbus Blvd.

Two bedroom/den, fireplace, panoramic bridge and river views, 1 car parking included.....\$290,000

Four bedroom + two bedroom townhouse panoramic water & bridge views.....\$1,100,000



Allan Domb Real Estate

Philadelphia's Largest Luxury Condominium REALTOR®

Telephone: 215-545-1500 Fax: 215-545-1090

1608 Walnut Street, Suite 1303, Philadelphia, PA 19103

Internet Address: www.allandomb.com

VISIT OUR WEB SITE AT <http://www.wnwr.com/shca>